



**東 北 大 学**

TOHOKU UNIVERSITY

March 31, 2024

**October 2023 Admission  
FGL Program Undergraduate Courses  
General Education Guidebook**

April 2024  
Tohoku University

# Table of Contents

	Page
● Academic Calendar of 2024 General Education Program.....	3
● Class Schedule of General Education Subjects.....	4
<b>I General Education</b> .....	5
1. Tohoku University's Admission/Diploma/Curriculum Policies for the Undergraduate Program	
2. Goals and Mission of General Education	
3. Terms & Semesters	
4. Classes & Credits	
5. General Education System	
<b>II Registering for General Education Subjects</b> .....	7
1. Registration Schedule	
2. Registration Group	
3. Registration Procedures	
4. Notes on Registration and Checking Grades	
5. Using Student-owned Computers for Educational Activities	
6. Campus Wi-Fi	
7. Internet School of Tohoku University (ISTU)	
8. Enrolling for Japanese Language	
<b>III Examinations, Grading and Reports</b> .....	11
1. Exam Schedule, Methods	
2. Notes on Examinations	
3. Makeup Examinations	
4. Grading	
5. GPA (Grade Point Average) System	
<b>IV Introduction to Class Contents</b> .....	13
1. Course Numbering Code	
2. Searching Syllabus Online	
1) Search by course, 2) Search by instructor, 3) Full-text search	
<b>V General Education Class Information (FGL Program)</b> .....	21
1. List of Subjects	
2. Timetable	
<b>VI Other</b> .....	27
1. Medical Care Required due to Accidents in Class	
2. Using Educational Facilities	
3. Counseling Services	
4. Preventing Theft	
● Regulations on Tohoku University General Education Subjects.....	28
● Kawauchi Campus Map.....	33
1) Campus Map [Kawauchi], 2) Classroom, 3) Laboratories, 4) Multimedia Education and Research Complex, 5) Gymnasium, 6) Sub Arena, 7) Education and Student Support Center, Student Service, 8) International Exchange Building	

## Academic Calendar of 2024 General Education Program

### Spring Semester

Orientation for the 3rd semester (Specialized subjects for each department)	<p><b>【AMC】</b> April 5 (Fri.) 10:00-12:00 Katahira Campus South Multidisciplinary Research Laboratory 2, 4th floor, Seminar Room</p> <p><b>【IMAC-U】</b> April 2 (Tue.) 12:30-16:45 Examination April 3 (Wed.) 10:00-11:00 Orientation</p> <p><b>【AMB】</b> There will be no course orientation.</p>
Classes in 3 <sup>rd</sup> Semester	<p>April 8 (Mon.) – August 5 (Mon.), 2024</p> <p>&lt;1Q&gt;April 8 (Mon.) – June 7 (Fri.), 2024</p> <p>&lt;2Q&gt;June 4 (Tue.) – August 5 (Mon.), 2024</p>
Class Registration by website	April 8 (Mon.) – April 19 (Fri.), 2024
Drop / Withdrawal for Class Registration	April 22 (Mon.) – May 10 (Fri), 2024
Semester-end Vacation	August 6 (Tue.) – September 30 (Mon.), 2024

### Fall Semester

Classes in 4 <sup>th</sup> Semester	<p>October 1 (Tue.) – February 3 (Mon.), 2025</p> <p>&lt;3Q&gt;October 1 (Tue.) – December 2 (Mon.), 2024</p> <p>&lt;4Q&gt;November 26 (Tue.) – February 3 (Mon.), 2025</p>
Class Registration by website	October 1 (Tue.) – October 14 (Mon.), 2024
Drop / Withdrawal for Class Registration	October 15 (Tue.) – October 31 (Thu.), 2024
Winter Break	December 27 (Fri.), 2024 – January 3 (Fri.), 2025
No classes due to National Center Test for University Admissions	January 17 (Fri.), 2025
Semester-end Vacation	February 4 (Tue), 2025 – late March

### Class Timetable

Period	Class start/finish	Comments
1st Period	8:50 - 10:20	A chime will sound when classes start/finish.
2nd Period	10:30 - 12:00	
3rd Period	13:00 - 14:30	
4th Period	14:40 - 16:10	
5th Period	16:20 - 17:50	

# Class Schedule of AY2024 General Education Subjects

(from April, 2024 to March, 2025)

		8+8	8+8	8+8	8+8	8+8		
2024	Apr.	Sun	Mon	Tue	Wed	Thu	Fri	Sat
		...	1	2	3	4	5	6
		7	8	9	10	11	12	13
		14	15	16	17	18	19	20
		21	22	23	24	25	26	27
28	29	30	...	...	...	...		
...	...	...	...	...	...	...	...	
2025	Oct.	Sun	Mon	Tue	Wed	Thu	Fri	Sat
		...	...	1	2	3	4	5
		6	7	8	9	10	11	12
		13	14	15	16	17	18	19
		20	21	22	23	24	25	26
27	28	29	30	31	...	...		
...	...	...	...	...	...	...		
2024	May	Sun	Mon	Tue	Wed	Thu	Fri	Sat
		...	...	...	1	2	3	4
		5	6	7	8	9	10	11
		12	13	14	15	16	17	18
		19	20	21	22	23	24	25
26	27	28	29	30	31	...		
...	...	...	...	...	...	...		
2025	Nov.	Sun	Mon	Tue	Wed	Thu	Fri	Sat
		...	...	...	...	...	1	2
		3	4	5	6	7	8	9
		10	11	12	13	14	15	16
		17	18	19	20	21	22	23
24	25	26	27	28	29	30		
...	...	...	...	...	...	...		
2024	Jun.	Sun	Mon	Tue	Wed	Thu	Fri	Sat
		...	...	...	...	...	...	1
		2	3	4	5	6	7	8
		9	10	11	12	13	14	15
		16	17	18	19	20	21	22
23	24	25	26	27	28	29		
30	...	...	...	...	...	...		
...	...	...	...	...	...	...		
2025	Dec.	Sun	Mon	Tue	Wed	Thu	Fri	Sat
		1	2	3	4	5	6	7
		8	9	10	11	12	13	14
		15	16	17	18	19	20	21
		22	23	24	25	26	27	28
29	30	31	...	...	...	...		
...	...	...	...	...	...	...		
2024	Jul.	Sun	Mon	Tue	Wed	Thu	Fri	Sat
		...	1	2	3	4	5	6
		7	8	9	10	11	12	13
		14	15	16	17	18	19	20
		21	22	23	24	25	26	27
28	29	30	31	...	...	...		
...	...	...	...	...	...	...		
2025	Jan.	Sun	Mon	Tue	Wed	Thu	Fri	Sat
		...	...	...	1	2	3	4
		5	6	7	8	9	10	11
		12	13	14	15	16	17	18
		19	20	21	22	23	24	25
26	27	28	29	30	31	...		
...	...	...	...	...	...	...		
2024	Aug.	Sun	Mon	Tue	Wed	Thu	Fri	Sat
		...	...	...	...	1	2	3
		4	5	6	7	8	9	10
		11	12	13	14	15	16	17
		18	19	20	21	22	23	24
25	26	27	28	29	30	31		
...	...	...	...	...	...	...		
2025	Feb.	Sun	Mon	Tue	Wed	Thu	Fri	Sat
		...	...	...	...	...	...	1
		2	3	4	5	6	7	8
		9	10	11	12	13	14	15
		16	17	18	19	20	21	22
23	24	25	26	27	28	...		
...	...	...	...	...	...	...		
2024	Sep.	Sun	Mon	Tue	Wed	Thu	Fri	Sat
		1	2	3	4	5	6	7
		8	9	10	11	12	13	14
		15	16	17	18	19	20	21
		22	23	24	25	26	27	28
29	30	...	...	...	...	...		
...	...	...	...	...	...	...		
2025	Mar.	Sun	Mon	Tue	Wed	Thu	Fri	Sat
		...	...	...	...	...	...	1
		2	3	4	5	6	7	8
		9	10	11	12	13	14	15
		16	17	18	19	20	21	22
23	24	25	26	27	28	29		
30	31	...	...	...	...	...		

Normal Classes    Intensive Classes    No classes (holidays, etc.)    Indicates end of quarter

- : Makeup class for Monday will be held on May 2 and January 29.  
Makeup class for Friday will be held on December 26 and January 28.
- ◇ : Class will be held on October 14 (Mon.) although it is a national holiday.

note: Class will be canceled on October 25(Fri.) for the University Festival.

# I General Education

## 1. Tohoku University's Admission/Diploma/Curriculum Policies for the Undergraduate Program

### ○Admission Policy

Tohoku University seeks students who sympathize with the university's mission, and who possess either/both of the following:

- (1) The desire to significantly contribute as researchers by seriously addressing the issues facing 21st century human society or
- (2) The desire to significantly contribute to the development of society as high-level professionals with abundant knowledge and leadership, and the strength of will, bold academic curiosity, and fundamentally excellent academic abilities to realize this desire.

### ○Diploma Policy

Tohoku University confers the bachelor's degree on students who achieve the following goals.

- (1) Obtain knowledge in their specialized fields and a multifaceted perspective based on an interest in and broad knowledge of academia in general.
- (2) Obtain the education necessary to become accomplished adults, and be able to contribute to society using expertise specific to their fields of specialization.
- (3) Have the awareness and vision to assume leadership/core roles in the global community while developing fundamental abilities.

### ○Curriculum Policy

Tohoku University structures and implements its educational curriculum as follows to ensure that students meet the goals described in the Diploma Policy.

- (1) Offer a curriculum that creates organic links between General Education Subjects to foster broad knowledge and education, and Specialized Subjects to confer basic knowledge of specialized fields.
- (2) Following the principle of "Research First," promote the development of educational methods and establishment of educational systems while implementing active learning both in and out of class.
- (3) Develop the students' ability to learn independently by evaluating learning achievements and applying the results.

## 2. Goals and Mission of General Education

The goals of this university's General Education program are to foster students who possess specialized knowledge that they can use in practical society and advanced research, comprehensive, modern knowledge and deep compassion, and an international perspective. It will fulfill basic educational requirements, providing the foundations for specialized and/or graduate education, and confer the below fundamental basic abilities, knowledge, and expertise:

- 1) Basic knowledge and expertise needed for modern, international citizens to lead a social life
- 2) Basic accomplishments and skills that will provide core character-building for the modern world
- 3) Knowledge and skills related to a wide range of academic fields to aid understanding in specialized majors
- 4) Basic knowledge and skills required to study more specialized areas

To fulfill its mission, General Education has a curriculum comprising four subject categories: Foundations, Advanced Subjects, Languages, and Basics of Discipline. Each category is made up of classes arranged in subject groups, which are implemented to achieve the goals below.

Foundations	<ul style="list-style-type: none"><li>▪ These subjects are comprised of Navigating Academia, Humanities, Social Sciences, Natural Sciences, and Transdisciplinary Subjects.</li><li>▪ In the Navigating Academia, the basic attitude of those involved in academic research is developed through understanding of how academic research should be conducted. In the Humanities, Social Sciences, and Natural Sciences, humanities students focus on science courses, while science students focus on humanities courses, thereby creating students who are knowledgeable in both the sciences and the humanities. In the Transdisciplinary Subjects, students will not be confined to their own specialized fields, but will be exposed to a variety of fields, and will develop a foundation for the ability to solve problems through collaboration with people from various fields.</li></ul>
-------------	--

Advanced Subjects	<ul style="list-style-type: none"> <li>• This group is composed of subjects dealing with Contemporary Competencies, and Cutting Edge Subjects.</li> <li>• Contemporary Competencies provide the knowledge/skills required of educated persons in the modern context, and foster the habit of taking ownership over problems that require global effort to solve. Cutting Edge Subjects stimulate awareness of what it means to study at a comprehensive research university and motivate academic research by providing contact with cutting edge scholarship, regardless of field.</li> </ul>
Languages	<ul style="list-style-type: none"> <li>• This category is composed of the Foreign Languages and Japanese groups.</li> <li>• It fosters language abilities and intercultural understanding necessary for modern/international/educated persons. It also aims to provide the English skills necessary for academic objectives, basic multilingual competence in the students' first and second foreign languages, and basic Japanese competence for international students.</li> </ul>
Basics of Discipline	<ul style="list-style-type: none"> <li>• This category is composed of the Basic Humanities, Basic Social Sciences, Basic Mathematics, Basic Physics, Basic Chemistry, Basic Biology, and Basic Earth and Space Science groups.</li> <li>• It is connected to the major fields of the undergraduate departments, and provides basic knowledge/skills needed for the relevant major.</li> </ul>

### 3. Terms & Semesters

Tohoku University uses a two-semester system, with the period of April 1 to September 30 defined as first semester, and October 1 to March 31 as second semester. The semester comprises the basic unit of the education curriculum; General Education lasts from the 2nd to 4th semesters. **FGL Students will begin classes from the 2nd Semester.**

1st Year	2nd Year				3rd & 4th Year
Fall	Spring		Fall		5th – 8 <sup>th</sup> /9 <sup>th</sup> Semester
2nd Semester	3rd Semester		4th Semester		
	1st Quarter	2nd Quarter	3rd Quarter	4th Quarter	

### 4. Classes & Credits

Each class is held 15 times (weeks) per semester, and consists of lectures, seminars, experiments, laboratory work, skill tests, or some combination of these. Some classes may be implemented in intensive lectures. The number of credits reflects the amount of academic work performed, with one credit requiring 45 hours of study. General Education subjects confer two credits in consideration of the methods used in class, educational effect, and amount of study required outside of class, as indicated below.

Class Format	Hours of Class	Content of Study
Lectures	30 hrs.	Students take 15 ninety-minute classes, a course of four-hour lectures, a 2-4 hour seminar, experiments, laboratory work, and skill tests, requiring 2 hours per class of preparation/review.
Seminars	30 - 60 hrs.	
Experiments, Laboratory Work, Skill Tests	60 - 90 hrs.	

General Education also uses different class format such as below.

- International Coeducational Seminar: "International Coeducation" fosters an attitude of acceptance and understanding for diversity among students of varying languages and cultures through collaborative group work and projects. It provides learning experiences that make students reexamine their own values and build new ones. International Coeducational Seminars provide these learning opportunities in a small-group seminar format.

## 5. General Education System

General Education is for all students at the university. The Academic Affairs Council, which is composed of educators from every department, is responsible for planning and operating its subject categories and groups and performs overall coordination and supervision. The Institute for Excellence in Higher Education (IEHE) also provides support for its university-wide system. The IEHE was founded in April 2014 by merging five independent educational organizations at Tohoku University in order to implement advanced liberal arts education and provide a higher level of student support. Instructors from each department of the faculties, graduate schools, research institutes/centers, and the university hospital are responsible for General Education classes, and take part in a supportive, cooperative university-wide class-management system to provide students an educational foundation with a broad perspective.

## II Registering for General Education Subjects

### 1. Registration Schedule

Students must register for classes in compliance with rules on required subjects (subjects which students must take), recommended subjects (classes that students are urged to take) and registration prerequisites (in cases where students cannot register for one class unless they have already completed another class) as per the student handbook for their faculty, and orientation.

The number of General Education subjects that are taught in English and open to Future Global Leadership Undergraduate Courses students is limited, so FGL students should register as per the Class Timetable for the FGL Courses.

#### Notes on General Education subjects Registration

- Classes that are not designated by your faculty's Student Guide will not be credited towards graduation requirements.
- Please register for classes in the appropriate semester, as listed in your faculty's Student Guide. You cannot register for a class before the appropriate semester (advanced registration) as designated by the faculty (department/division).
- Students cannot register for two subjects with the same subject name, even if the topics, instructors, semester, and day/time of the two subjects are different. The same applies to taking a subject with the same name as one for which the student has already received credit.

### 2. Registration Group

As class schedules are drawn up with consideration for class sizes in each faculty/year/division, in general you must register within groups created for your own faculty (own division). In principle, you cannot register for classes in groups other than those created for your own faculty (i.e. in other divisions).

Even in classes held for your own faculty, groups are sometimes further subdivided by Student ID Number.

For classes outside your division, it is possible that you will not be given permission to register due to the class content or class size.

### 3. Method of conducting classes (Online class system)

The classes will be conducted mainly in face-to-face classes held on campus, with an effective combination of online classes according to the content and characteristics of each class. Please refer to the FGL website to see if online classes are scheduled.

**FGL Website:** <https://www.insc.tohoku.ac.jp/english/fgl-current-students/>

#### ① ISTU/DC System (ISTU on the Digital Campus System)

ISTU provides online access to class videos and materials. ISTU is used with a Tohoku University ID.

URL: <https://www.dc.tohoku.ac.jp/en/>

#### ② Google Classroom

Google Classroom is an online class system provided by Google, Inc. To view videos and materials for classes using Google Classroom, each student must add his/her own classes within Google Classroom using a "Class Code" for Google Classroom. (Note: "Class codes" are not "course numbering" or "lecture codes" on the syllabus.) The class codes for Google Classroom are listed in the FGL website.

#### ③ Google Meet

Google Meet is a videoconferencing system that runs in a web browser and can be used with a DC Mail account.

#### ④ Microsoft Teams

This is a system that allows you to conduct video conferences using the Teams application or a web browser. Use the Microsoft 365 ID assigned to each student. Please see the guide below for details.

URL: <https://www.cds.tohoku.ac.jp/en/ees-en/>

For other information, please check the Tohoku University Online Course Guide.

URL: <https://olg.cds.tohoku.ac.jp/home>

#### 4. Registration Procedures

To register for classes (and receive credits), it is necessary to complete the registration procedures. **If you do not undergo Web-based registration, you will not receive credit for classes even if you attend the lectures and take the exams.**

The registration procedures are Web-based. In general, the classes you enter cannot be changed except during the Web-based registration confirmation/revision period. During this period, please check your registration details online, and make any necessary changes at the Student Affairs Division.

Web-based registration is performed separately for each semester. You can also check your grades and credits online.

You should inquire at the FGL office when registering for classes outside your division.

For classes for which you have registered, please check the syllabus and prepare for the online class system (ISTU or Google Classroom) you plan to use.

#### 5. Notes on Registration and Checking Grades

##### (1) Web-based registration, confirmation/revision period

Spring semester: April 8 (Mon.) – April 19 (Fri.)

Fall semester: October 1 (Tue.) – October 14 (Mon.)

- ① Course registration will be conducted via the Student Affairs Information System website during the above period per semester.

**Student Affairs Information System: <https://slink.secioss.com/user/index.php?tenant=auth.tohoku.ac.jp>**

\*The Operation Manual is available from the following website.

<https://rp.auth.tohoku.ac.jp/gkms/manual/index.html>



\*It requires a Tohoku University ID and password to perform Web-based registration.

\*The server will receive heavy access on the final day of registration, so try to finish registering your classes before then.

\*Remember that "Google Classroom" is not official class registration. Please be sure to register both. So does canceling classes.

- ② Be sure to click the "Confirm Entry" button on the Web-based registration page.
- ③ Please register once during the first week of the registration period in order for the instructors to know the number of registered students.
- \*Once you have registered for classes, you can change your registration as many times as you like during the course registration period. Please note that registration may be closed earlier at the instructors' judgment. If an instructor provides instructions on the syllabus or learning support systems such as Google Classroom, please follow it by completing course registration by the designated date, regardless of the deadline for web registration.
- ④ After the deadline, it is unable to change registration. Please confirm your registration carefully in advance.
- ⑤ Please be sure to register and confirm your course registration as early as possible, as the system connection may not always be successful due to heavy access on the deadline.
- ⑥ If you have added classes to Google Classroom during the online registration period but did not register for them in the end, or if they were not approved due to course registration adjustments, please cancel your Google Classroom registration on your own. Also, please do not add classes to Google Classroom for which you have not registered. (This may cause confusion, such as differences between the actual number of students and the number of students registered in Google Classroom. )

##### (2) Procedures for deregistering classes

Spring semester: April 22 (Mon.) – May 10 (Fri.)

Fall semester: October 15 (Tue.) – October 31 (Thu.)

- ① If you wish to "deregister" a class for which you have finalized registration, you must ask the course instructor to get approval by email and submit class cancellation form during the designated period above.

Use DC Mail account when you send an e-mail to the instructor as your identification.

\*Class cancellation form will be informed by Academic Affairs Division in advance.



- ② **If you perform the required procedures, you will not be graded for that class, and your grades will show an "E" (deregistered) instead.**
- ③ **By registering for a class, you commit to taking that class and being graded on it. If you abandon a class before completing it, you will receive a D grade (Fail).**

### **(3) Confirming grades**

Spring semester: will be announced on August 21 (Wed.)

Fall semester: will be announced on February 14 (Fri.)

- ① Please confirm your grades online using the "Grades Inquiry" screen via Student Affairs Information System. If you set a "Private key for the SRP image-matrix authentication" from the campus network, you will be able to check your grades from off-campus using the SRP. (For details, see: <https://www.dc.tohoku.ac.jp/guide/srp/srp-e.html>)
- ② For details on grading, please see "III Examinations, Grading and Reports."

### **6. Using Student-owned Computers for Educational Activities**

For some time, Tohoku University has used CALL materials for foreign language education and learning management, and we encourage students to use their own laptop computers for educational purposes in order to improve the educational reach of the ICT-based on-demand lectures we offer. Please check the General Education class syllabi to see whether your classes require a computer.

### **7. Campus Wi-Fi**

All campuses have Wi-Fi access points in key locations for wireless Internet service (via eduroam). For connection instructions and other details, please refer to "Online Guide: Information Services for Education in Tohoku University" (<https://www.dc.tohoku.ac.jp/guide/wifi/wifi.html>).



### **8. Enrolling for Japanese Language**

Students on the FGL Courses are required to take 10 credits of Japanese language. Students who have taken the "Japanese Language Proficiency Test" or the "Examination for Japanese University Admission for International Students" and met certain conditions, specified elsewhere, may apply to have their test results recognized in place of coursework, and receive up to seven of the required 10 Japanese language credits.

International students at this university who have obtained a designated number of points on Japanese language tests etc. shall be considered to have completed a Japanese language class, and shall be awarded a predetermined number of credits upon application.

1. As per Articles 26-6 and 26-7 of the Tohoku University Faculty Regulations, and as elsewhere stipulated by the Minister of Education, Culture, Sports, Science and Technology, students who have obtained the specified number of points on the Japanese language tests etc., and students for whom it is recognized to be educationally beneficial by their faculty, shall be considered by this University to have completed a Japanese language class, and shall be awarded credits, as stipulated by the rules of their faculty.
2. Faculties that may approve these credits are as follows.  
Faculty of Science, School of Engineering, Faculty of Agriculture (students belonging to Future Global Leadership Undergraduate Courses)
3. Languages subjects for which these credits can be awarded are as follows.  
Japanese
4. Subjects for which credits can be awarded, Japanese language tests, criterion for recognition, and number of credits are as follows.  
Recognized subjects: Basic Japanese I, Basic Japanese II and Intermediate Japanese are certified in that order. The maximum number of approved credits is 7.  
Name of Test:
  - i) Japanese Language Proficiency Test—JLPT (Japan Educational Exchanges and Services)
  - ii) Examination for Japanese University Admission for International Students—EJU (Japan Student Services Organization)

Criterion and Number of Credits:

Criterion	Number of Credits	Score	Subject
JLPT N3 or higher	7	AA	Basic Japanese I(4 Credits)
		AA	Basic Japanese II(3 credits)
		AA	Intermediate Japanese(3 credits)
JLPT N4	7	AA	Basic Japanese I(4 Credits)
		AA	Basic Japanese II(3 credits)
JLPT N5	4	AA	Basic Japanese I(4 Credits)
EJU 220 points or higher (Not including Writing)	7	AA	Basic Japanese I(4 Credits)
		AA	Basic Japanese II(3 credits)
		AA	Intermediate Japanese(3 credits)
EJU 200 points or higher (Not including Writing)	7	AA	Basic Japanese I(4 Credits)
		AA	Basic Japanese II(3 credits)

5. Application Instructions
  - i) Documents required for the application are the application form and a copy of the test certificate or score sheet.
  - ii) The date entered on the test certificate or score sheet must be less than two years prior to the date of application.
6. Certification Procedure
  - i) Certification of credits will be performed by the Japanese Language Committee of the Academic Affairs Council (hereafter, Japanese Language Committee) based on a copy of the test certificate or score sheet.
  - ii) Results of screenings by the Japanese Language Committee will be reported to the Educational Records and Programs Committee of the Academic Affairs Council.
  - iii) Credits for applications submitted before the end of January or the end of June will be certified the same semester; credits for applications submitted after February 1 or July 1 will be certified the following semester
7. Any items necessary for credit certification, other than those specified in this agreement, will be specified by the Japanese Language Committee.

Enacted on January 5, 2011 (enforced on October 1, 2011)

\*Japanese class; Intermediate Japanese (3 credits)

Students who feel that the class does not match their Japanese abilities may instead select 3 subjects (3 credits) from the General Education Japanese A-J classes (1 credit each; aimed at advanced JLPT N1-level students). These subjects are held for privately financed international students belonging to degree courses taught in Japanese.

If you wish to do this, speak to your Japanese language instructor in advance to confirm that your abilities will be sufficient before registering. Inquire with the FGL staff in the Student Exchange Division or General Education Operating Section in the Educational Affairs Division for the Japanese A-J timetable.

## III Examinations, Grading and Reports

### 1. Exam Schedule, Methods

Examinations will be conducted by class instructors during the course. Please follow your instructor's directions when taking examinations. Information on examinations may sometimes be announced on bulletin board so please check them carefully.

Grading methods for each subject are described in the syllabus.

### 2. Notes on Examinations

When submitting written exams and reports (includes short reports and minute papers that effect student grades) for General Education subjects, never engage in misconduct as described below. Also, please comply with all of the following Notes on Written Examinations. If any misconduct is detected in written examinations or reports, those involved will be subject to severe disciplinary measures.

#### <Notes on Written Examinations>

1. Follow the exam proctor's instructions and refrain from any misconduct.
2. Please fill seats in the exam room starting from the front row.
3. Place your student ID card on your desk during the examination.
4. Except for writing utensils, place all personal items (especially mobile devices such as smartphones) in your bag. Do not leave them on your desk or keep them on your person. You may use a dictionary etc. only if permitted to do so.
5. Writing mats may be used only if permitted by the proctor.

#### <Definition of Misconduct>

##### Written Examinations

- (1) Taking an exam in place of another person, or having another person take an exam in your place.
- (2) Using unauthorized textbooks, dictionaries, reference materials, notes, memos, etc. during the examination.
- (3) Peeking at other people's answers, showing others your answers, receiving answers from others, etc.
- (4) Exchanging answers with others.
- (5) Keeping items such as smartphones, mobile devices, notes, etc on your desk or on your person instead of placing them in your bag etc. as instructed.
- (6) Behavior that is contrary to the proctor's instructions and/or disrupts the fair administration of the examination.
- (7) Any other behavior that is deemed to be equivalent to the above.

##### Reports etc. (including short reports and minute papers that effect student grades)

- (1) Plagiarism: Ex. quoting your own or another author's copyrighted work or websites without citing a source, using content from another student's report
- (2) Fabrication: Ex. creating nonexistent test results and data, quoting nonexistent (fictitious) sources
- (3) Alteration: Ex. deliberately altering data and processes, manufacturing inauthentic results
- (4) Any other activities forbidden by the class instructor for the reason that they would prevent accurate evaluation of learning achievements. Ex. Using generative AI without the instructor's permission and submitting its output as your own work, or providing the content of reports to other students etc.

### 3. Makeup Examinations, etc.

If you are unable to take an examination, etc., due to illness, accident, or bereavement (loss of an immediate family member), you can apply through the Student Affairs Division to take a makeup examination within three days (including the day of the examination)) after the end of the relevant examination, excluding Saturdays, Sundays, and national holidays. The following documents are required.

- For illness: Doctor's diagnosis
- For accidents: Accident Report Form
- For bereavement: Corroborating documentation

### 4. Grading

Grading is described in the syllabus for each subject.

However, grading for General Education subjects is handled as follows.

(Grading)

1. Grading for General Education subjects is as follows.

Grade	Description of Evaluation	Criteria for Points (out of 100)
AA	The student's performance was particularly exceptional.	90 – 100 points
A	The student's performance was excellent.	80 – 89 points
B	The student's performance was above average.	70 – 79 points
C	The student passed.	60 – 69 points.
D	The student failed or quit the class.	59 points or below
E	The student deregistered as per the proscribed procedures.	—

Comments

- 1) Grading and evaluation will take into account examination performance, reports submitted, attendance, and registration status.
  - 2) The "AA" grade was implemented for incoming students in the 2004 academic year onward; for students who enrolled prior to 2004, there is no distinction between the "AA" and "A" grades.
  - 3) The grade designated as "E" will be given under the following conditions.
    - a) If the student deregisters at the Student Affairs Division during a designated period.
    - b) The student takes a leave of absence, or withdraws, from the university
  - 4) This grading system is effective as of the subjects taught in the 2013 academic year onward.
2. The syllabus will provide descriptions of educational goals (academic achievement goals) and specific evaluation methods for each subject; in general, absolute evaluations will be based on the correspondence of student performance with the educational goals set for each subject.
3. Class instructors shall store student examination answer sheets for one year from the date of the examination, and reports, etc. for one year from their due date, to serve as a basis for grading and to respond to any requests for information disclosure from students. However, this requirement does not apply to reports that are returned to the students with grades/comments; in the case of examination answer sheets, it is recommended that the instructor store the original and return a copy. (Reference: Tohoku University Criteria on Length of Storage Period for Documents: One year or less for examination answer sheets and reports.)

(Accepting questions)

4. Students can receive an explanation of the grade evaluation from the class instructor of the class by requesting it to the Academic Affairs Division only within a designated period of time following the announcement of grades. However, if a student is unable, for legitimate reasons, to make this request during that period, the student can receive an explanation at a later time, as long as it is within the one-year storage period.

(Complaint)

5. If the student is unsatisfied with the grade, the student can file a petition with the chairperson of the Educational Records and Programs Committee of the Academic Affairs Council (hereafter "Educational Records and Programs Committee"), through the Academic Affairs Division only within a specified period. However, if a student is unable, for legitimate reasons, to make this request during that period, the student can file a petition at a later time, as long as it is within the one-year storage period.
6. Upon receiving a petition of dissatisfaction, the Educational Records and Programs Committee shall set up a subcommittee, composed of several members to investigate its validity.

(Publication of Grading)

7. The Grading Improvement Committee of the Academic Affairs Council shall compile and analyze grades and release their findings to the class instructors and students.

\* Designated period is within two weeks after the announcement of grades.

\* A petition of dissatisfaction should be filed when the student is still unsatisfied after hearing the class instructor's explanation regarding the grade, not when the student who failed the class wishes to take a makeup exam. Students should not visit instructor's office without an appointment.

## 5. GPA (Grade Point Average) System

In FY 2016, the GPA system was adopted by Tohoku University to increase the students' academic motivation, contribute to the provision of appropriate learning guidance, promote rigorous grade evaluation, and improve the quality of learning. The GPA system will be applied to undergraduate curriculum students who enter in FY 2016 and later.

Discretion on how to utilize GPA is left up to the individual faculties.

➤ **Grades and GP**

Grade Points (GP) will be assigned in accordance with each faculty's regulations, faculty-specific regulations on registration, and the regulations on General Education, as per the following table.

Evaluation		GP
Letter Grade	Score	
AA	100-90	4.0
A	89-80	3.0
B	79-70	2.0
C	69-60	1.0
D	59-0	0.0

➤ **GPA Categories and Calculation Method**

Tohoku University has two types of GPA: one that indicates learning progress and achievements for the relevant semester (hereafter "semester GPA"), and one that indicates learning progress and achievements for the entire period of enrollment at the university (hereafter "cumulative GPA").

The semester and cumulative GPAs will be calculated with the below formulas, and the resulting numbers rounded to the 3rd decimal place.

$$\text{Semester GPA} = \frac{\text{Total of (GP for each class evaluated for the semester} \times \text{the number of credits for relevant classes)}}{\text{Total credits for the classes evaluated for the semester}}$$

$$\text{Cumulative GPA} = \frac{\text{Total of (GP for each class evaluated during the entire enrollment period} \times \text{the number of credits for relevant classes)}}{\text{Total credits for the classes evaluated for the entire enrollment period.}}$$

➤ **Classes Affecting GPA**

The below classes will be excluded from the student's semester and cumulative GPAs.

- 1) Classes for which the student has, by the prescribed date applied and received permission to cancel the registration.
- 2) Classes designated by the Chairperson of the Academic Affairs Council, or the Faculty Dean or Department Director.

## IV Introduction to Class Contents

### 1. Course Numbering Code

#### A) Course Numbering

Course Numbering is a system in which codes indicating a variety of information of each class, such as subject category and levels of difficulty, to clarify the curriculum structure.

By assigning codes and numbers to each class has a unique code to clarify its difficulty level/characteristics, significance, and the sequence in which courses should be taken, students can understand which classes they should register for, the role of each class within the undergraduate/graduate curriculum, and each course's objectives.

Also, clarifying course levels is expected to facilitate credit transfers with overseas universities.

#### B) Coding Method

Course Numbering at Tohoku University is organized as follows.

In general, the codes will be fixed for each class instead of being reassigned every academic year. However, codes may be reassigned in some cases, such as when there are major revisions to the class content.

#### a) Example of Course Numbering Code

A BC - (hyphen) DEF 1 23 G  
① ② ③ ④ ⑤ ⑥

#### b) Meanings of Each Segment of the Code:

- ① Hosting Faculty/School
- ② Department/Major (for General Education etc., subject category/group)
- ③ Academic Field
- ④ Level/Characteristics
- ⑤ Classification Number
- ⑥ Language Used in Class

**c) List of Each Segment Code**

① List of Hosting Faculty/School Codes (single letter)

These codes are the same as the letter that indicates the student's faculty/graduate school, shown as the third letter of the student ID number; General Education Subjects (faculty code: Z) and Teacher Training Subjects (faculty code: Q) were assigned letters not already in use.

Faculty/Graduate School	Faculty Code
Faculty of Science/Graduate School of Science	S
School of Engineering/Graduate School of Engineering	T
Faculty of Agriculture/Graduate School of Agricultural Science	A

Faculty/Graduate School	Faculty Code
General Education Subjects	Z
Teacher Training Subjects	Q

② List of Department/Major Codes (two letters) \*Those for only General Education are shown here.

General Education	Foundations	Navigating Academia	FA
		Humanities	FH
		Social Sciences	FS
		Natural Sciences	FN
		Transdisciplinary Subjects	FT
	Advanced Subjects	Contemporary Competencies	AC
		Cutting Edge Subjects	AE
	Languages	Foreign Languages	LF
		Japanese	LJ
	Basics of Discipline	Basics of Humanities	DU
		Basics of Social Sciences	DO
		Basics of Mathematics	DM
		Basics of Physics	DP
		Basics of Chemistry	DC
		Basics of Biology	DB
		Basics of Earth and Space Science	DE
	Teacher Training Subjects		TL

③ Academic Field Codes (three letters)

As shown in "III Course Numbering for General Education"

④ List of Levels/Characteristic Codes (one number) \*only General Education is shown here

Class Type/Group/Subject			Code
Foundations	Navigating Academia	Introduction to Academic Learning, Seminar on Each Discipline for Academic Learning	1
		Advanced General Education Course	2
		Humanities, Social Sciences, Natural Sciences	1
	Transdisciplinary Subjects	Integrated Experiments of Science, Health & Sports (Sports), Health & Sports (Lecture)	1
		Other than above	8
Advanced Subjects	Contemporary Competencies (Information Science and Technology Education)	Information and Data Literacy	1
	Contemporary Competencies (Subjects related to study abroad and internships)		9
	Other than above		8
Languages	Foreign Languages (English)	English I-A, I-B, II-A, II-B	1
		English III, III (e-learning)	2
	Foreign Languages (Languages for Multilinguality)	Basic *** (Language) I, II	1
		Intermediate *** (Language) I, II, III, IV, Practical *** (Language) I, II	2
	Other than above		1
Basics of Discipline			1
Teacher Training Subjects	Practical Seminar on Teaching Profession		4
	Other		1

⑤ Classification Number (two numbers)

Classification Numbers are assigned for Course Numbering administration purposes; they are not sequential.

⑥ Codes for Language Used in Class (one letter)

Languages used in classes will be coded as follows.

Language Used	Code
Japanese	J
English	E
Non-English foreign languages	F
Two or more languages	B

These codes will be assigned per class, in accordance with the syllabus for the relevant academic year.

(Ex.)

General Education Subject "Foundation of Calculus" CB12345(Japanese) ZDN-MAT104J

General Education Subject "Foundation of Calculus" CB67890 (English) ZDN-MAT104E

## 2. Searching Syllabus Online

Course syllabi can be viewed in the Student Affairs Information System. It requires your Tohoku University ID and password to log into the system. While syllabi may additionally be viewed in other locations such as the university websites and the QuickSyllabus, the posting in the Student Affairs Information System is the most up-to-date information.

The Student Affairs Information System:

<https://slink.secioss.com/user/index.php?tenant=authtohoku.ac.jp/>



Top Page

Requires Tohoku University ID and password to log in. Contact the FGL Office if you have any questions.  
For more information on image-matrix authentication, please refer to the online guide.  
<https://sites.google.com/tohoku.ac.jp/oids-out/sso>

Off-campus access



One-time password or FIDO authentication (face, fingerprint, etc.)



Change the language to English.

Click "Home" or "配置 / 言語設定", then you will see the page "配置 / 言語設定 (language settings)".



コンテンツ名	横幅	横位置	縦位置	幅可変
講義のお知らせ			2	<input checked="" type="checkbox"/>
お知らせ表示(全体)			1	<input checked="" type="checkbox"/>
お知らせ表示(個人宛)			2	<input checked="" type="checkbox"/>
スケジュール表示(日)			1	<input checked="" type="checkbox"/>
スケジュール表示(週間)	3	0	0	<input type="checkbox"/>

After selecting "English", click the button "更新 (update)". To change the language, you are required to log out, and then log in again. Click “ログアウト (log out)” on the top right.

言語設定

言語  Japanese  English

推奨設定に戻す クリア 更新

- キャビネット一覧
- 個人種別選択
- ユーザー設定
- 配置/言語設定
- アカウントリセット

リンク

センター

- 教育系情報システム
- 全学教育シラバス

### Online syllabus search

HOME | School Affairs | Courses/Grades | Student Services | Job-search Support | **Syllabus** <<Usage Time 7:00>>

Search from Course

Search Condition

Search by selecting school year to search a syllabus and specifying each search conditions

Selection screen for the types of search will be displayed on the right:

- Search from Course
- Search by Instructor
- Search Entire Text
- Online Manual

School Year	2024	School Year					
Curriculum	--Not Selectd--	<input type="checkbox"/> Exc					
Field and Category	--Not Selectd--	(If you want to specify a field and category, you must select Curriculum.)					
Target Grade	--Not Selectd--	(If you want to specify a target grade, you must select curriculum.)					
Course Name	<input type="text"/>						
Instructor in Charge	<input type="text"/>						
Class Starting Time	--Not Selectd--						
	Mon	Tue	Wed	Thu	Fri	Sat	Other
1	<input type="checkbox"/>	<input type="checkbox"/>	<input type="checkbox"/>	<input type="checkbox"/>	<input type="checkbox"/>	<input type="checkbox"/>	<input type="checkbox"/>
1(First half)	<input type="checkbox"/>	<input type="checkbox"/>	<input type="checkbox"/>	<input type="checkbox"/>	<input type="checkbox"/>	<input type="checkbox"/>	<input type="checkbox"/>
1(Second half)	<input type="checkbox"/>	<input type="checkbox"/>	<input type="checkbox"/>	<input type="checkbox"/>	<input type="checkbox"/>	<input type="checkbox"/>	<input type="checkbox"/>
2	<input type="checkbox"/>	<input type="checkbox"/>	<input type="checkbox"/>	<input type="checkbox"/>	<input type="checkbox"/>	<input type="checkbox"/>	<input type="checkbox"/>
2(First half)	<input type="checkbox"/>	<input type="checkbox"/>	<input type="checkbox"/>	<input type="checkbox"/>	<input type="checkbox"/>	<input type="checkbox"/>	<input type="checkbox"/>
2(Second half)	<input type="checkbox"/>	<input type="checkbox"/>	<input type="checkbox"/>	<input type="checkbox"/>	<input type="checkbox"/>	<input type="checkbox"/>	<input type="checkbox"/>

## (1) Search by Course

When planning registration this allows you to efficiently check the timetable, search for only subjects for which you are eligible to register, and browse them by day/class time. Use “Search from Course” to do this.

### Search from Course

---

**Search Condition**

 Search by selecting school year to search a syllabus and specifying each search conditions

Search Syllabus

<input type="radio"/> School Year	2024 <input type="button" value="v"/> School Year																																																																																																																
<input type="radio"/> Curriculum	--Not Selectd-- <input type="button" value="v"/> <input type="checkbox"/> Excluding Other Department																																																																																																																
<input type="radio"/> Field and Category	--Not Selectd-- <input type="button" value="v"/> <small>(If you want to specify a field and category, you must select Curriculum.)</small>																																																																																																																
<input type="radio"/> Target Year	--Not Selectd-- <input type="button" value="v"/> <small>(If you want to specify a target grade, you must select curriculum.)</small>																																																																																																																
<input type="radio"/> Course Name	<input type="text"/>																																																																																																																
<input type="radio"/> Instructor in Charge	<input type="text"/>																																																																																																																
<input type="radio"/> Class Starting Time	--Not Selectd-- <input type="button" value="v"/>																																																																																																																
<input type="radio"/> Subject Numbering	<input type="text"/> <input type="checkbox"/>																																																																																																																
<input type="radio"/> Faculty	--Not Selectd--																																																																																																																
<input type="radio"/> Department	--Not Selectd-- <input type="button" value="v"/>																																																																																																																
<input type="radio"/> Academic Disciplines	--Not Selectd-- <input type="button" value="v"/>																																																																																																																
<input type="radio"/> Level	--Not Selectd-- <input type="button" value="v"/>																																																																																																																
<input type="radio"/> Used Language	--Not Selectd-- <input type="button" value="v"/>																																																																																																																
<input type="radio"/> Class Period	<table border="1" style="width: 100%; border-collapse: collapse; text-align: center;"><thead><tr><th></th><th>Mon</th><th>Tue</th><th>Wed</th><th>Thu</th><th>Fri</th><th>Sat</th><th>Other</th></tr></thead><tbody><tr><td>1</td><td><input type="checkbox"/></td><td><input type="checkbox"/></td><td><input type="checkbox"/></td><td><input type="checkbox"/></td><td><input type="checkbox"/></td><td><input type="checkbox"/></td><td><input type="checkbox"/></td></tr><tr><td>4(Second half)</td><td><input type="checkbox"/></td><td><input type="checkbox"/></td><td><input type="checkbox"/></td><td><input type="checkbox"/></td><td><input type="checkbox"/></td><td><input type="checkbox"/></td><td><input type="checkbox"/></td></tr><tr><td>5</td><td><input type="checkbox"/></td><td><input type="checkbox"/></td><td><input type="checkbox"/></td><td><input type="checkbox"/></td><td><input type="checkbox"/></td><td><input type="checkbox"/></td><td><input type="checkbox"/></td></tr><tr><td>5(First half)</td><td><input type="checkbox"/></td><td><input type="checkbox"/></td><td><input type="checkbox"/></td><td><input type="checkbox"/></td><td><input type="checkbox"/></td><td><input type="checkbox"/></td><td><input type="checkbox"/></td></tr><tr><td>5(Second half)</td><td><input type="checkbox"/></td><td><input type="checkbox"/></td><td><input type="checkbox"/></td><td><input type="checkbox"/></td><td><input type="checkbox"/></td><td><input type="checkbox"/></td><td><input type="checkbox"/></td></tr><tr><td>6</td><td><input type="checkbox"/></td><td><input type="checkbox"/></td><td><input type="checkbox"/></td><td><input type="checkbox"/></td><td><input type="checkbox"/></td><td><input type="checkbox"/></td><td><input type="checkbox"/></td></tr><tr><td>6(First half)</td><td><input type="checkbox"/></td><td><input type="checkbox"/></td><td><input type="checkbox"/></td><td><input type="checkbox"/></td><td><input type="checkbox"/></td><td><input type="checkbox"/></td><td><input type="checkbox"/></td></tr><tr><td>6(Second half)</td><td><input type="checkbox"/></td><td><input type="checkbox"/></td><td><input type="checkbox"/></td><td><input type="checkbox"/></td><td><input type="checkbox"/></td><td><input type="checkbox"/></td><td><input type="checkbox"/></td></tr><tr><td>7</td><td><input type="checkbox"/></td><td><input type="checkbox"/></td><td><input type="checkbox"/></td><td><input type="checkbox"/></td><td><input type="checkbox"/></td><td><input type="checkbox"/></td><td><input type="checkbox"/></td></tr><tr><td>7(First half)</td><td><input type="checkbox"/></td><td><input type="checkbox"/></td><td><input type="checkbox"/></td><td><input type="checkbox"/></td><td><input type="checkbox"/></td><td><input type="checkbox"/></td><td><input type="checkbox"/></td></tr><tr><td>7(Second half)</td><td><input type="checkbox"/></td><td><input type="checkbox"/></td><td><input type="checkbox"/></td><td><input type="checkbox"/></td><td><input type="checkbox"/></td><td><input type="checkbox"/></td><td><input type="checkbox"/></td></tr><tr><td>Team lecture</td><td><input type="checkbox"/></td><td><input type="checkbox"/></td><td><input type="checkbox"/></td><td><input type="checkbox"/></td><td><input type="checkbox"/></td><td><input type="checkbox"/></td><td><input type="checkbox"/></td></tr><tr><td>Other</td><td><input type="checkbox"/></td><td><input type="checkbox"/></td><td><input type="checkbox"/></td><td><input type="checkbox"/></td><td><input type="checkbox"/></td><td><input type="checkbox"/></td><td><input type="checkbox"/></td></tr></tbody></table> <p><small>(If you want to specify the class period, you must select the class starting time.)</small></p>		Mon	Tue	Wed	Thu	Fri	Sat	Other	1	<input type="checkbox"/>	<input type="checkbox"/>	<input type="checkbox"/>	<input type="checkbox"/>	<input type="checkbox"/>	<input type="checkbox"/>	<input type="checkbox"/>	4(Second half)	<input type="checkbox"/>	<input type="checkbox"/>	<input type="checkbox"/>	<input type="checkbox"/>	<input type="checkbox"/>	<input type="checkbox"/>	<input type="checkbox"/>	5	<input type="checkbox"/>	<input type="checkbox"/>	<input type="checkbox"/>	<input type="checkbox"/>	<input type="checkbox"/>	<input type="checkbox"/>	<input type="checkbox"/>	5(First half)	<input type="checkbox"/>	<input type="checkbox"/>	<input type="checkbox"/>	<input type="checkbox"/>	<input type="checkbox"/>	<input type="checkbox"/>	<input type="checkbox"/>	5(Second half)	<input type="checkbox"/>	<input type="checkbox"/>	<input type="checkbox"/>	<input type="checkbox"/>	<input type="checkbox"/>	<input type="checkbox"/>	<input type="checkbox"/>	6	<input type="checkbox"/>	<input type="checkbox"/>	<input type="checkbox"/>	<input type="checkbox"/>	<input type="checkbox"/>	<input type="checkbox"/>	<input type="checkbox"/>	6(First half)	<input type="checkbox"/>	<input type="checkbox"/>	<input type="checkbox"/>	<input type="checkbox"/>	<input type="checkbox"/>	<input type="checkbox"/>	<input type="checkbox"/>	6(Second half)	<input type="checkbox"/>	<input type="checkbox"/>	<input type="checkbox"/>	<input type="checkbox"/>	<input type="checkbox"/>	<input type="checkbox"/>	<input type="checkbox"/>	7	<input type="checkbox"/>	<input type="checkbox"/>	<input type="checkbox"/>	<input type="checkbox"/>	<input type="checkbox"/>	<input type="checkbox"/>	<input type="checkbox"/>	7(First half)	<input type="checkbox"/>	<input type="checkbox"/>	<input type="checkbox"/>	<input type="checkbox"/>	<input type="checkbox"/>	<input type="checkbox"/>	<input type="checkbox"/>	7(Second half)	<input type="checkbox"/>	<input type="checkbox"/>	<input type="checkbox"/>	<input type="checkbox"/>	<input type="checkbox"/>	<input type="checkbox"/>	<input type="checkbox"/>	Team lecture	<input type="checkbox"/>	<input type="checkbox"/>	<input type="checkbox"/>	<input type="checkbox"/>	<input type="checkbox"/>	<input type="checkbox"/>	<input type="checkbox"/>	Other	<input type="checkbox"/>	<input type="checkbox"/>	<input type="checkbox"/>	<input type="checkbox"/>	<input type="checkbox"/>	<input type="checkbox"/>	<input type="checkbox"/>
	Mon	Tue	Wed	Thu	Fri	Sat	Other																																																																																																										
1	<input type="checkbox"/>	<input type="checkbox"/>	<input type="checkbox"/>	<input type="checkbox"/>	<input type="checkbox"/>	<input type="checkbox"/>	<input type="checkbox"/>																																																																																																										
4(Second half)	<input type="checkbox"/>	<input type="checkbox"/>	<input type="checkbox"/>	<input type="checkbox"/>	<input type="checkbox"/>	<input type="checkbox"/>	<input type="checkbox"/>																																																																																																										
5	<input type="checkbox"/>	<input type="checkbox"/>	<input type="checkbox"/>	<input type="checkbox"/>	<input type="checkbox"/>	<input type="checkbox"/>	<input type="checkbox"/>																																																																																																										
5(First half)	<input type="checkbox"/>	<input type="checkbox"/>	<input type="checkbox"/>	<input type="checkbox"/>	<input type="checkbox"/>	<input type="checkbox"/>	<input type="checkbox"/>																																																																																																										
5(Second half)	<input type="checkbox"/>	<input type="checkbox"/>	<input type="checkbox"/>	<input type="checkbox"/>	<input type="checkbox"/>	<input type="checkbox"/>	<input type="checkbox"/>																																																																																																										
6	<input type="checkbox"/>	<input type="checkbox"/>	<input type="checkbox"/>	<input type="checkbox"/>	<input type="checkbox"/>	<input type="checkbox"/>	<input type="checkbox"/>																																																																																																										
6(First half)	<input type="checkbox"/>	<input type="checkbox"/>	<input type="checkbox"/>	<input type="checkbox"/>	<input type="checkbox"/>	<input type="checkbox"/>	<input type="checkbox"/>																																																																																																										
6(Second half)	<input type="checkbox"/>	<input type="checkbox"/>	<input type="checkbox"/>	<input type="checkbox"/>	<input type="checkbox"/>	<input type="checkbox"/>	<input type="checkbox"/>																																																																																																										
7	<input type="checkbox"/>	<input type="checkbox"/>	<input type="checkbox"/>	<input type="checkbox"/>	<input type="checkbox"/>	<input type="checkbox"/>	<input type="checkbox"/>																																																																																																										
7(First half)	<input type="checkbox"/>	<input type="checkbox"/>	<input type="checkbox"/>	<input type="checkbox"/>	<input type="checkbox"/>	<input type="checkbox"/>	<input type="checkbox"/>																																																																																																										
7(Second half)	<input type="checkbox"/>	<input type="checkbox"/>	<input type="checkbox"/>	<input type="checkbox"/>	<input type="checkbox"/>	<input type="checkbox"/>	<input type="checkbox"/>																																																																																																										
Team lecture	<input type="checkbox"/>	<input type="checkbox"/>	<input type="checkbox"/>	<input type="checkbox"/>	<input type="checkbox"/>	<input type="checkbox"/>	<input type="checkbox"/>																																																																																																										
Other	<input type="checkbox"/>	<input type="checkbox"/>	<input type="checkbox"/>	<input type="checkbox"/>	<input type="checkbox"/>	<input type="checkbox"/>	<input type="checkbox"/>																																																																																																										

Search Syllabus

You can narrow the search results by curriculum, course name, instructor name, etc. Instructor name must be entered in **all capital letters**.

Select the day/time, e.g. 1 x Tue for classes held in first period on Tuesdays. When the class period is checked, the class starting time also must be selected.

After making your selections, click the search button. A list of classes for which you are eligible to register will be displayed as per your search criteria.

A list of classes will be displayed as per the search criteria.

**Search from Course**

[Return to Previous Screen](#)

**Course List**

Click the course name which you want to refer to a syllabus.

1-10/28 1 2 3 Next 10>> 10 ▾

No	Course Code	Course Name	Class Starting Period	Instructor in Charge
1	CB22119	<a href="#">Logic</a>	Spring Semester Tue 2	KAZUHISA SHINOZAWA
2	CB22307	<a href="#">Sports A</a>		HIGE
3	CB22308	<a href="#">Sports A</a>		I
4	CB22309	<a href="#">Sports A</a>	Spring Semester Tue 2	AKIRA TAMAGAWA
5	CB22310	<a href="#">Sports A</a>	Spring Semester Tue 2	AKIRA SATO
6	CB22311	<a href="#">Sports A</a>	Spring Semester Tue 2	TOSHIHIKO FUJIMOTO
7	CB22130	<a href="#">Physics A</a>	Spring Semester Tue 2	TOMOHIKO IWASAKI
8	CB22131	<a href="#">Physics A</a>	Spring Semester Tue 2	MASATOSHI ITOH
9	CB22132	<a href="#">Physics A</a>	Spring Semester Tue 2	YOSHIRO HIRAYAMA
10	CB22120	<a href="#">Philosophy</a>	Spring Semester Tue 2	ICHIRO MORI

You can view a class's syllabus by clicking the class title.

1-10/28 1 2 3 Next 10>> 10 ▾

**Syllabus Screen**

**Browse Syllabus**

[Return to Search Result List](#)

[Add to Your Favorite](#)

Subject	Biology B
Day/Period/Place	Spring Semester Tue 2 川北キャンパスA204
Categories	General Education Subjects - Expansion Subjects-Biology
Credit(s)	2
Object	国際学士コース(*)
Instructor (Position)	ROBERT MARTIN 所属:高度教養教育・学生支援機構
Term	3セメスター
Course Numbering	ZDN-BIO112E
Language Used in Course	English

Class Subject	Essential Biochemistry
Object and Summary of Class	Biochemistry is a vast field that covers the structure, function, and interconversion of the biomolecules that characterize living systems. The main objective of this course is for the student to acquire a fundamental understanding about biomolecules, proteins, enzymes, and catalysis as well as getting an overview of some of the central metabolic pathways.

## (2) Search by Instructor

This allows you to search by class instructor. If you know the instructor name, this search is the easiest way to view the syllabus.

**Search by Instructor**

**Search Condition**

Select a year that you want to search syllabus and search instructor.

School Year	2024 ▼
Name	ROBERT
Full-time/Part-time	<input type="checkbox"/> Full-time <input type="checkbox"/> Part-time

Instructor name must be entered in **all capital letters**.

Search Instructor

## (3) Full-Text Search

This allows you to search for words/text contained in the syllabi.

**Search Entire Text**

**Search Condition**

[Search Entire Text] then, you can search for summary of class for which you can't search by [Search from Course] and [Search by Instructor]. Select a year that you want to search syllabus and enter the search keyword.

School Year	2024 ▼
Search Keyword	organic chemistry

Including all of The

Search Sy

Multiple keywords can be entered with a space between words.

## ● QuickSyllabus

QuickSyllabus is a website that allows you to quickly search syllabi without logging in. The website is only available in Japanese, but the syllabus itself is available in English if the course is conducted in English. Note that the contact information of instructors is NOT posted in QuickSyllabus.

QuickSyllabus: <https://qsl.cds.tohoku.ac.jp>

## V General Education Class Information (FGL Program)

### 1. List of Subjects (2<sup>nd</sup>, 3<sup>rd</sup>, and 4<sup>th</sup> Semester Classes)

Category	Group 1	Group 2	Subject	Credits	Semester	Courses	
Foundations	Navigating Academia	-	Introduction to Academic Learning	2	2	AMC IMAC-U AMB	
	Humanities	-	History	2	2	AMC IMAC-U AMB	
	Social Sciences	-	Economy and Society	2	2	AMC IMAC-U AMB	
	Natural Sciences	Mathematics	Foundations of Linear Algebra	2	3	AMB	
			Foundations of Calculus	2	2	AMB	
	Transdisciplinary Subjects	Life	Life and Nature	2	2	AMC IMAC-U AMB	
			Integrated Experiments of Science	2	3	AMC IMAC-U AMB	
			Health & Sports (Sports)	Sports A	1	3	IMAC-U
					4	4	AMC AMB
	Health & Sports (Lecture)	Health	2	4	AMC IMAC-U AMB		
Advanced Subjects	Contemporary Competencies	Information Science and Technology Education	Information and Data Literacy	2	2	AMC IMAC-U AMB	
		International Education	Study-abroad Program A (Fundamentals of Interdisciplinary STEM Seminar)	1	2	AMC IMAC-U AMB	
		Career Education	Special Lecture of Career Education (Digital Entrepreneurship Seminar)	2	4	AMC IMAC-U AMB	
Languages	Japanese	Japanese	Basic Japanese I	4	2	AMC IMAC-U AMB	
			Basic Japanese II	3	3	AMC IMAC-U AMB	
			Intermediate Japanese	3	4	AMC IMAC-U AMB	



Category	Group 1	Group 2	Subject	Credits	Semester	Courses
Basics of Discipline	Basics of Mathematics	-	Linear Algebra A	2	2	AMC IMAC-U
			Linear Algebra B	2	3	AMC IMAC-U
			Calculus A	2	2	AMC IMAC-U
			Calculus B	2	3	AMC IMAC-U
			Ordinary Differential Equations	2	4	AMC IMAC-U
			Probability & Statistics	2	4	AMC IMAC-U AMB
	Basics of Physics	-	Physics A	2	2	AMC IMAC-U AMB
			Physics B	2	3	AMC IMAC-U AMB
			Physics C	2	3	AMC IMAC-U AMB
	Basics of Chemistry	-	Chemistry A	2	2	AMC IMAC-U AMB
			Chemistry B	2	2	AMC IMAC-U AMB
			Chemistry C	2	3	AMC IMAC-U AMB
	Basics of Biology	-	Biology A	2	2	AMC IMAC-U AMB
			Biology B	2	3	AMC AMB
			Biology C	2	3	AMC AMB
	Basics of Earth and Space Science	-	Earth Material Science	2	2	AMC IMAC-U AMB

✘For subjects other than those listed above, please refer to the orientation for each course.

## 2. Timetable

ATTN: When you register for courses, be sure to select the English courses for FGL students that match the instructor names below.

### (1) AMC Course

General Education Subjects

Specialized Subjects

### 3<sup>rd</sup> Semester (April 2024– September 2024)

	8:50 - 10:20	10:30 - 12:00	13:00 - 14:30	14:40 - 16:10	16:20 - 17:50
Mon.	生命科学 C <b>Biology C</b> Kazuo INABA South Multidisciplinary Research Laboratory 2 AMC Classroom (302)	専門基礎化学 I <b>Special Class in Basic Chemistry I</b> Eriko NANGO	生物化学概論 <b>General Biochemistry</b> Satoshi TAKAHASHI Eriko NANGO Fumi NAGATSUGI	専門基礎化学 III <b>Special Class in Basic Chemistry III</b> Takehiko WADA	
Tue.	日本語 <b>Basic Japanese II</b> Wataru NAKAMURA Masako HAYASHI <b>A204</b>	解析学 B <b>Calculus B</b> Xavier DAHAN <b>C203</b>	生命科学 B <b>Biology B</b> Toshiharu ICHINOSE etc <b>C203</b>		
Wed.	物理学 C <b>Physics C</b> Takeshi KOIKE <b>R115</b>	日本語 <b>Basic Japanese II</b> Wataru NAKAMURA Masako HAYASHI <b>A204</b>	化学 C <b>Chemistry C</b> Mott Derrick <b>R115</b>		
Thu.		物理学 B <b>Physics B</b> Dmytro FEDORYNENKO <b>R115</b>	自然科学総合実験 <b>Introductory Science Experiments</b> Itaru NAKAMURA et al. <b>[A06] Student Laboratories</b>		日本語 <b>Basic Japanese II</b> Wataru NAKAMURA Masako HAYASHI <b>A204</b>
Fri.		線形代数学 B <b>Linear Algebra B</b> Alexander GAVRILYUK <b>C203</b>	専門基礎化学 II-IV <b>Special Class in Basic Chemistry II, IV</b> Brian Keith, BREEDLOVE		

### 4<sup>th</sup> Semester (October 2024 – March 2025)

	8:50 - 10:20	10:30 - 12:00	13:00 - 14:30	14:40 - 16:10	16:20 - 17:50
Mon.		物理化学概論 B <b>General Physical Chemistry B</b> Hiroshi KUMIGASHIRA	物理化学演習 A <b>Exercises in Physical Chemistry A</b> Tadahiro KOMEDA	無機分析化学概論 B <b>General Inorganic and Analytical Chemistry B</b> Brian Keith, BREEDLOVE	
Tue.	数理統計学 <b>Probability &amp; Statistics</b> TBA <b>C204</b>	日本語 <b>Intermediate Japanese</b> Yukari AZUMI Yuna MIKODA <b>C204</b>	常微分方程式論 <b>Ordinary Differential Equations</b> Xavier DAHAN <b>C404</b>	日本の産業と科学技術 <b>Science, Technology and Industry in Japan</b> TBA <b>A204</b>	キャリア教育特別講義 <b>Special Lecture of Career Education (Digital Entrepreneurship Seminar)</b> Takeshi KOIKE <b>C203</b>
Wed.	日本語 <b>Intermediate Japanese</b> Yukari AZUMI Yuna MIKODA <b>C204</b>	日本語 <b>Intermediate Japanese</b> Yukari AZUMI Yuna MIKODA <b>C204</b>			
Thu.		生物化学 IA <b>Biochemistry IA</b> South Multidisciplinary Research 2 Satoshi TAKAHASHI	有機化学演習 A <b>Exercises in Organic Chemistry A</b> Fumi NAGATSUGI, Takehiko WADA, Shin MIZUKAMI		
Fri.	無機分析化学概論 A <b>General Inorganic and Analytical Chemistry A</b> Brian Keith, BREEDLOVE	有機化学概論 A <b>General Organic Chemistry A</b> Shin MIZUKAMI	スポーツ A <b>Sports A*</b> Haruki MONMA, etc.	体と健康 <b>Health</b> TBA <b>C203</b>	

Notice: \*Students will choose one of the sports activities for Sports A.

\*Students will choose one of the Introductory Seminar.

(2) IMAC-U Course

General Education Subjects

Specialized Subjects

3<sup>rd</sup> Semester (April 2024 – September 2024)

	8:50 - 10:20	10:30 - 12:00	13:00 - 14:30	14:40 - 16:10	16:20 - 17:50
Mon.	<2Q> 数学 II <b>Mathematics II</b> Takashi FURUSAWA	<1Q>力学 <b>Mechanics</b> Anna SUZUKI <2Q>数理解析学 <b>Numerical Analysis</b> Kanjuro MAKIHARA	<1Q>数学 I <b>Mathematics I</b> Masayuki TAKAHASHI	<1Q>数理情報学演習 <b>Exercises in Computer-Aided Problem Solving</b> Takayuki OKATANI Hiraku MATSUKUMA	
Tue.	日本語 <b>Basic Japanese II</b> Wataru NAKAMURA Masako HAYASHI <b>A204</b>	解析学B <b>Calculus B</b> Xavier DAHAN <b>C203</b>	スポーツA <b>Sports A*</b> Akira TAMAGAWA, etc		
Wed.	物理学 C <b>Physics C</b> Takeshi KOIKE <b>R115</b>	日本語 <b>Basic Japanese II</b> Wataru NAKAMURA Masako HAYASHI <b>A204</b>	化学 C <b>Chemistry C</b> Mott Derrick <b>R115</b>	数学物理学演習 II <b>Exercises in Mathematics and Physics II</b> Ying CHEN	
Thu.		物理学 B <b>Physics B</b> Dmytro FEDORYNENKO <b>R115</b>	自然科学総合実験 <b>Introductory Science Experiments</b> Itaru NAKAMURA et al. <b>[A06] Student Laboratories</b>	日本語 <b>Basic Japanese II</b> Wataru NAKAMURA Masako HAYASHI <b>A204</b>	
Fri.	<1Q>力学 <b>Mechanics</b> Anna SUZUKI	線形代数学B <b>Linear Algebra B</b> Alexander GAVRILYUK <b>C203</b>	<1Q>数学 I <b>Mathematics I</b> Masayuki TAKAHASHI  <2Q>数学 II <b>Mathematics II</b> Takashi FURUSAWA	<1Q>数理情報学演習 <b>Exercises in Computer-Aided Problem Solving</b> Takayuki OKATANI Hikaru MATSUKUMA <2Q>数理解析学 <b>Numerical Analysis</b> Kanjuro MAKIHARA	

4<sup>th</sup> Semester (October 2024 – March 2025)

	8:50 - 10:20	10:30 - 12:00	13:00 - 14:30	14:40 - 16:10	16:20 - 17:50
Mon.	<3Q>量子力学 I <b>Quantum Mechanics</b> Wataru YASHIRO <4Q>材料力学 II <b>Mechanics of Materials II</b> Takeshi YAMAGUCHI Go YAMAMOTO	<3Q>機械力学 I <b>Mechanical Vibrations I</b> Mitsuhiro HAYASHIBE, Fedorynenko DMYTRO <4Q>制御工学 I <b>Control Engineering I</b> Dai OWAKI	<3Q>材料力学 I <b>Mechanics of Materials I</b> Yuji ICHIKAWA Yoichi TAKEDA  <4Q>流体力学 I <b>Fluid Mechanics I</b> Takehiko SATO		
Tue.	数理統計学 <b>Probability &amp; Statistics</b> TBA <b>C204</b>	日本語 <b>Intermediate Japanese</b> Yukari AZUMI Yuna MIKODA <b>C204</b>	常微分方程式論 <b>Ordinary Differential Equations</b> Xavier DAHAN <b>C404</b>	日本の産業と科学技術 <b>Science, Technology and Industry in Japan</b> TBA <b>A204</b>	キャリア教育特別講義 <b>Special Lecture of Career Education (Digital Entrepreneurship Seminar)</b> Takeshi KOIKE <b>C203</b>
Wed.	日本語 <b>Intermediate Japanese</b> Yukari AZUMI Yuna MIKODA <b>C204</b>	日本語 <b>Intermediate Japanese</b> Yukari AZUMI Yuna MIKODA <b>C204</b>	機械知能・航空研修 I <b>Seminar I</b>	<3Q>情報処理演習 <b>Practice of Information Processing</b> Makoto HIROTA <4Q>コンピューター実習 I <b>Computer Seminar I</b>	
Thu.	<3Q>量子力学 I <b>Quantum Mechanics</b> Wataru YASHIRO <4Q>材料力学II <b>Mechanics of Materials II</b> Takeshi YAMAGUCHI Go YAMAMOTO	<3Q>熱力学 I <b>Thermodynamics I</b> Takashi TOKUMASU Akihiro HAYAKAWA <4Q>材料科学 I <b>Materials Science I</b> Kazuhisa SATO Yuji ICHIKAWA	<3Q>材料力学 I <b>Mechanics of Materials I</b> Yuji ICHIKAWA Yoichi TAKEDA <4Q>流体力学 I <b>Fluid Mechanics I</b> Takehiko SATO		
Fri.	<3Q>熱力学 I <b>Thermodynamics I</b> Takashi TOKUMASU Akihiro HAYAKAWA <4Q>材料科学 I <b>Materials Science I</b> Kazuhisa SATO Yuji ICHIKAWA	<3Q>機械力学 <b>Mechanical Vibrations I</b> Mitsuhiro HAYASHIBE, Fedorynenko DMYTRO <4Q>制御工学 I <b>Control Engineering I</b> Dai OWAKI	機械知能・航空研修 I <b>Seminar I</b>	体と健康 <b>Health</b> TBA <b>C203</b>	
Int ens	創造工学研修 <b>Team-Based Engineering for Invention</b> Instructor and students will arrange and decide the schedule of this lesson.				

Notice: \*See the IMAC-U timetable for details of Specialized Subject Classes.

\*Students will choose one of the sports activities for Sports A.

\*Students will choose one of Introductory Seminar.



**(3) AMB Course**

General Education Subjects

Specialized Subjects

**3<sup>rd</sup> Semester (April 2024 – September 2024)**

	8:50 - 10:20	10:30 - 12:00	13:00 - 14:30	14:40 - 16:10	16:20 - 17:50
Mon.	生命科学 C <b>Biology C</b> Kazuo INABA <b>C103</b>				
Tue.	日本語 <b>Basic Japanese II</b> Wataru NAKAMURA Masako HAYASHI <b>A204</b>	解析学B <b>Calculus B</b> Xavier DAHAN <b>C203</b>	生命科学 B <b>Biology B</b> Toshiharu ICHINOSE etc <b>C203</b>	線形代数学概論 <b>Foundations of Linear Algebra</b> Xavier DAHAN <b>C203</b>	
Wed.	物理学 C <b>Physics C</b> Takeshi KOIKE <b>R115</b>	日本語 <b>Basic Japanese II</b> Wataru NAKAMURA Masako HAYASHI <b>A204</b>	化学 C <b>Chemistry C</b> Mott Derrick <b>R115</b>		
Thu.		物理学 B <b>Physics B</b> Dmytro FEDORYNENKO <b>R115</b>	自然科学総合実験 <b>Introductory Science Experiments</b> Itaru NAKAMURA et al. <b>[A06] Student Laboratories</b>		日本語 <b>Basic Japanese II</b> Wataru NAKAMURA Masako HAYASHI <b>A204</b>
Fri.	(1Q) 水圏無脊椎動物学 <b>Aquatic Invertebrate Biology</b> Lecture Room 9		現代における農と農学 <b>Modern Agriculture and Agricultural Science</b>	陸圏・水圏環境コミュニケーション論 <b>Introduction to Aquatic Production / Introduction to Natural and Agricultural Production</b>	
Intensive course	臨海実習 <b>Practice on Marine Bio-resources Science</b>				

**4<sup>th</sup> Semester (October 2024– March 2025)**

	8:50 - 10:20	10:30 - 12:00	13:00 - 14:30	14:40 - 16:10	16:20 - 17:50
Mon.			<3Q> 水産遺伝育種学 <b>Fish Genetics and Breeding science</b> Lecture Room 8		
Tue	数理統計学 <b>Probability &amp; Statistics</b> TBA <b>C204</b>	日本語 <b>Intermediate Japanese</b> Yukari AZUMI Yuna MIKODA <b>C204</b>	常微分方程式論 <b>Ordinary Differential Equations</b> Xavier DAHAN <b>C404</b>	日本の産業と科学技術 <b>Science, Technology and Industry in Japan</b> TBA <b>A204</b>	キャリア教育特別講義 <b>Special Lecture of Career Education (Digital Entrepreneurship Seminar)</b> Takeshi KOIKE <b>C203</b>
Wed.	日本語 <b>Intermediate Japanese</b> Yukari AZUMI Yuna MIKODA <b>C204</b>	日本語 <b>Intermediate Japanese</b> Yukari AZUMI Yuna MIKODA <b>C204</b>			
Thu.	<4Q> 海洋生物学 <b>Marine Biology</b> Lecture Room 8				
Fri.		水産科学概論 <b>Introduction to Fisheries Science</b> Lecture Room 8	スポーツ A <b>Sports A</b> Haruki MONMA, etc.	体と健康 <b>Health</b> TBA <b>C203</b>	

Notice: \*Students will choose one of the sports activities for Sports A.

\*Students will choose one of the Introductory Seminar.

## 2. Syllabus (2<sup>nd</sup> Semester)

– Available on the FGL Current Students website or Student Affairs Information System.

### **Cooperative Innovation Program in Science, Engineering, and Agriculture for Leading Sustainable and Diverse Industry and Society by Digital Globalization**

The FGL program has been selected by MEXT for a new program aimed at government-sponsored students. As a result, starting in FY 2021, FGL will be able to accept 8 government-sponsored students each year for three years. The objective of this program is to create an educational system based on cooperation between three undergraduate schools that will foster leaders in the field of global sustainable and diverse industry and society while driving innovation in university education.

Those who enter FGL as government-sponsored students will also belong to this new program. Therefore, in addition to the curricula of their undergraduate schools, the government-sponsored students will have to fulfill the requirements of this program as well. The program requirements (i.e. requirements for receiving government sponsorship) consist of nine or ten credits in the below six subjects. For details of each subject, please see the syllabus. From 1. to 4. below are General Education subjects.

1. Introduction to Academic Learning [2 credits] — General Education Subjects
2. Life and Nature (Study of Nature, Life and Technology) [2 credits] — General Education Subjects
3. Study Abroad Program A [1 credits] — General Education Subjects
4. Digital Entrepreneurship Seminar [2 credits] — General Education Subjects
5. Science, Technology, and Industry in Japan [1 credit] — Specialized Subjects
6. Multidisciplinary Internship [1 credit] — Specialized Subjects

## VI Other

### 1. Medical Care Required due to Accidents in Class

Students who suffer accidents during class should contact the Student Health Care Center and make arrangements to receive medical care.

### 2. Using Educational Facilities

Some facilities on campus may be closed or offer limited service to prevent the spread of COVID-19. Please check the university websites or inquire the FGL office for the latest information.

(1) ICL Rooms	ICL Rooms at the Multimedia Education and Research Complex can be used for self-study any time they are not being used for classes.
(2) Lounge	There is a lounge in Building B on the 1st floor. You may use it for taking online classes or resting in the time between classes etc.
(3) Study Room	The Study Room is in Building B on the 2nd floor. It is open from 8:30 to 18:00. Please refrain from making noise in the Study Room. On each desk, there is an outlet that you can use to charge your laptop.
(4) SLA Lounge	There is a SLA (Student Learning Adviser) desk, where students can go for consulting near the entrance hall on the 1st floor of the Multimedia Education and Research Complex, and it can be used for study or breaks. Senior students will answer questions and provide advice on various subjects. Please see the Center for Learning Support website for details.

### 3. Counseling Services

Students requiring counseling from someone other than their class instructors or department staff should contact the below counseling services. The details of counseling will be kept strictly confidential. (No Charge)

(1) Center for Counseling and Disability Services	<ul style="list-style-type: none"><li>▪ Center for Counseling and disability Services provides consulting regarding problems that arise during student life. Appropriate solutions will be discussed with the student.</li><li>▪ Location: Kawauchi Kita Campus, Tel: 795-7833</li><li>▪ Hours: Mon. - Fri. 9:30 - 17:00</li></ul>
(2) Student Health Care Center	<ul style="list-style-type: none"><li>▪ The goal of the Student Health Care Center is to maintain and improve student health. Students who have questions, concerns or anxiety about their physical or psychological health should make use of this facility. The first aid offices at Katahira, Schools of Medicine/Dentistry, School of Engineering, and Faculty of Agriculture also provide medical consulting and care.</li><li>▪ Location: Kawauchi Kita Campus, Tel: 795-7829</li><li>▪ Hours: Weekdays 9:00 - 11:30, 13:00 - 16:15</li></ul>
(3) University-wide Harassment Counseling Center	<ul style="list-style-type: none"><li>▪ Location: Kawauchi Kita Campus University Counseling Center, Tel: 022-795-7812</li><li>▪ Hours: Mon. - Fri., 9:30 - 17:00</li></ul>
(4) Counseling by Phone (Provided through off-campus organization)	<ul style="list-style-type: none"><li>▪ Counseling regarding sexual harassment, health, mental health</li><li>▪ Toll-free hotline: 0120-7830-59</li><li>▪ Hours: Mon., Wed., Fri., Sat., Sun. 10:00 - 21:00 Tue., Thu. 10:00 - 22:00 (not available on national holidays, Dec. 31 – Jan. 3)</li></ul>

### 4. Preventing Theft

(1) Incidences of theft in lecture halls and gymnasiums are fairly common. Do not leave bags etc. unattended in classrooms or study rooms, even for short periods of time. In the event of theft, report the incident to your Student Affairs Division or Student Services Division.

(2) There are numerous incidences of bicycle theft on Kawauchi Campus. When parking bicycles, lock them securely and do not leave them unattended for long periods of time.

● **Regulations on Tohoku University General Education Subjects**

April 1, 1993 Reg. 91

(Purport)

Article 1: These regulations specify items necessary to General Education Subjects and subjects related to education (does not include those established by the faculties; hereafter "General Education Subjects") in compliance with Article 26-2 of the Tohoku University Faculty Regulations (enacted December 18, 1952; hereafter "the Regulations").

(General Education Subjects)

Article 2: Categories of General Education Subjects are as follows.

Category	Group	
Foundations	Navigating Academia, Humanities, Social Sciences	
	Natural Sciences	Mathematics, Physics, Chemistry, Biology, Earth and Space Science
	Transdisciplinary Subjects	Society, Energy, Life, Environment, Information, Integrated Experiments of Science, Health & Sports (Sports), Health & Sports (Lecture)
Advanced Subjects	Contemporary Competencies	Information Science and Technology Education, International Education, Career Education, Global Issues
	Cutting Edge Subjects	Current Topics, Frontier Topics
Languages	Foreign Languages	English, Languages for Multilinguality, Languages for Further Multilinguality
	Japanese	
Basics of Discipline	Basics of Humanities, Basics of Social Sciences, Basics of Mathematics, Basics of Physics, Basics of Chemistry, Basics of Biology, Basics of Earth and Space Science	

(Course Subjects and Credits)

Article 3: Course subjects for General Education subjects and credits are as shown in Tables 1 and 2.

(Calculation of Credits)

Article 4: Calculation of credits for General Education course subjects are as follows.

I 1 (one) credit will be awarded per 15 hours of class time.

II 1 (one) credit will be awarded per 15 to 30 hours of seminar.

III 1 (one) credit will be awarded per 30 to 45 hours of experiments, laboratory work, and practical training.

(Registration Procedures)

Article 5: Students must inform the Chairperson of the Academic Affairs Council (hereafter, "the Chairperson") of the subjects for which they intend to register by the designated date.

(Examinations)

Article 6: Accreditation for course subjects for which students register will depend on examinations; those who pass their examinations shall receive the designated number of credits.

2 Regardless of the previous item, performance in classes consisting of experiments, laboratory work and practical training shall be graded based on daily performance instead of examinations.

3 For course subjects in which examinations can be given, the above article only applies to those who have enrolled in the class via the designated procedures.

(Makeup Examinations and Retesting)

Article 7: If, due to unavoidable circumstances, a student is unable to take a course subject's examination, a makeup test for that subject shall be conducted.

3. There will be no retesting for students who failed a course subject's examination.

(Grading Scale)

Article 8: Examination performance shall be evaluated as per the below scale. However, depending on the course subject, the grade may be specified as just "Pass" or "Fail."

AA The student's performance was particularly exceptional.

A The student's performance was excellent.

B The student's performance was above average.

C The student passed.

D The student failed.

2. Of the above grades, AA, A, B, and C are passing grades, while D is a failing grade.

3. Students who fail to attend a class for which they have submitted registration as per Article 5 above, shall receive a D grade on that class's examinations.

(Special Auditing Students)

Article 9: Students of other universities, junior colleges, or technical colleges who wish to enroll in General Education subjects may be permitted to enroll as Special Auditing Students, pursuant to agreements with that other university, junior college, or technical college.

(Miscellaneous Provisions)

Article 10: Any items necessary for General Education subjects, other than those specified in these regulations, will be specified by the Academic Affairs Council.

Supplementary Regulations Omitted

Table 1: General Education Subjects

Category	Group	Subject	Total class hours	Credits	Comments			
Foundations	Navigating Academia	Introduction to Academic Learning	30	2				
		Seminar on Each Discipline for Academic Learning	30	1				
		Advanced General Education Course	15~30	1				
	Humanities		Logic	30	2			
			Philosophy	30	2			
			Ethics	30	2			
			Literature	30	2			
			Religious Studies	30	2			
			Fine Art	30	2			
			Education	30	2			
			History	30	2			
			Linguistics and Japanese Language Sciences	30	2			
			Psychology	30	2			
			Cultural Anthropology	30	2			
	Sociology	30	2					
	Social Sciences		Economy and Society	30	2			
			Japanese Constitutional Law	30	2			
			Law	30	2			
			Politics	30	2			
			Politics and Economics in the Information Society	30	2			
			Law, Politics and Society	30	2			
	Natural Sciences	Mathematics	Introduction to Linear Algebra	30	2			
			Foundations of Linear Algebra	30	2			
			Introduction to Calculus	30	2			
			Foundations of Calculus	30	2			
			Introduction to Statistics	30	2			
			Foundations of Probability & Statistics	30	2			
		Physics	Physics	Introduction to Physics	30	2		
				Foundations of Physics I	30	2		
				Foundations of Physics II	30	2		
		Chemistry	Chemistry	Introduction to Chemistry	30	2		
		Biology	Biology	Introduction to Biology	30	2		
				Earth and Space Science	Introduction to Astronomy	30	2	
					Introduction to Environmental Earth Science	30	2	
				Introduction to Geography	30	2		
		Transdisciplinary Subjects		Society	Inclusive Society	30	2	
Energy	Energy, Resources and Sustainability			30	2			
Life	Life and Nature			30	2			
Environment	Nature and Environment			30	2			
Information	Information Science and Technology in Human Life and Society			30	2			
	Introduction to Area Studies on Northeast Asia			30	2			
Integrated Experiments of Science	Introductory Science Experiments			60	2			
	Introductory Science Experiments for the Humanities			60	2			
Health & Sports (Sports)	Sports A			30	1			
	Sports B			30	1			
Health & Sports (Lecture)	Health			30	2			
	Sports and Health Sciences	30	2					

Category	Group		Subject	Total class hours	Credits	Comments
Advanced Subjects	Contemporary Competencies	Information Science and Technology Education	Information and Data Literacy	30	2	Course subjects to be taught will be determined yearly.
			Introduction to Data Science and Artificial Intelligence	30	2	
			Introduction to Algorithms for Machine Learning	30	2	
			Hands-on Machine Learning I	30	2	
			Hands-on Machine Learning II	30	2	
			Special Lecture of Information Science and Technology Education	30	2	
		International Education	Understanding International Issues	30	2	
			PBL in Global Issues	30	2	
			Special Topics on Global Issues	30	2	
			Understanding Culture	30	2	
			Exploring Culture and Society	30	2	
			Multicultural Communication	30	2	
			PBL in Multicultural Environment	30	2	
			Special Topics on Multicultural Society	30	2	
			Global Seminar	30	2	
			Global Career	30	2	
			Global Leadership Development through PBL	30	2	
			Special Topics on Global Leadership	30	2	
			Study-abroad Semester	15~30	1	
				30~60	2	
				60~90	3	
				90~120	4	
				120~150	5	
		150~180		6		
		Study-abroad Program A	45	1		
		Study-abroad Program B	90	2		
		Faculty-led Program A	45	1		
		Faculty-led Program B	90	2		
		International Exploration A	45	1		
		International Exploration B	90	2		
		Career Education	Introduction to Entrepreneurial Skills	30	2	
			Workshop for Designing Your Future	30	2	
			Career Design A	30	2	
			Career Design B	30	2	
			Career Design C	30	2	
			Career Design D	30	2	
			Preparation Course for Career Practical Training and Internship	15	1	
			Career Practical Training and Internship A	15	1	
			Career Practical Training and Internship B	30	2	
			Transferable Skills Workshop	30	2	
			Special Lecture of Career Education	30	2	
		Global Issues	Sustainability and Social Co-Creation	30	2	
			Global Governance and Sustainable Development in SDGs	30	2	
			Resilient Design for the Sustainable Society	30	2	
			Sustainable Development For Society	30	2	
			System Design Towards a Sustainable Society	30	2	
			Gender Co-Creation Society	30	2	
Cutting Edge Subjects	Current Topics		7.5	0.5	Course subjects to be taught will be determined yearly.	
			15~30	1		
	Frontier Topics		30~60	2		
			30	2		

Category	Group		Subject	Total class hours	Credits	Comments		
Languages	Foreign Languages	English	English I-A	30	1			
			English I-B	30	1			
			English II-A	30	1			
			English II-B	30	1			
			English III	30	1			
			English III (e-learning)	30	1			
		Foreign Languages			Basic German I		60	2
					Basic German II		60	2
					Intermediate German I		30	2
					Intermediate German II		30	2
					Intermediate German III		30	2
					Intermediate German IV		30	2
					Basic French I		60	2
					Basic French II		60	2
					Intermediate French I		30	2
					Intermediate French II		30	2
					Intermediate French III		30	2
					Intermediate French IV		30	2
					Practical French I		30	2
					Practical French II		30	2
					Basic Russian I		60	2
					Basic Russian II		60	2
					Intermediate Russian I		30	2
					Intermediate Russian II		30	2
					Intermediate Russian III		30	2
					Intermediate Russian IV		30	2
					Basic Spanish I		60	2
					Basic Spanish II		60	2
					Intermediate Spanish I		30	2
					Intermediate Spanish II		30	2
					Practical Spanish I		30	2
					Practical Spanish II		30	2
					Basic Chinese I		60	2
	Basic Chinese II	60	2					
	Intermediate Chinese I	30	2					
	Intermediate Chinese II	30	2					
	Intermediate Chinese III	30	2					
	Intermediate Chinese IV	30	2					
	Basic Korean I	60	2					
	Basic Korean II	60	2					
	Intermediate Korean I	30	2					
	Intermediate Korean II	30	2					
	Intermediate Korean III	30	2					
	Intermediate Korean IV	30	2					
	Other Languages			Greek I	30		2	
				Greek II	30		2	
				Sanskrit I	30		2	
				Sanskrit II	30		2	
				Latin I	30		2	
				Latin II	30		2	
				Mongolian I	30		2	
				Mongolian II	30		2	
				Italian I	30		2	
Italian II				30	2			
Czech I				30	2			
Czech II				30	2			
Arabic I				30	2			
Arabic II				30	2			
Japanese			Japanese A	30	1	These subjects are for international students.		
			Japanese B	30	1			
			Japanese C	30	1			
			Japanese D	30	1			
			Japanese E	30	1			
			Japanese F	30	1			
			Japanese G	30	1			
			Japanese H	30	1			
			Japanese I	30	1			
			Japanese J	30	1			
			Basic Japanese I	120	4		These subjects are for the FGL Undergraduate Courses.	
			Basic Japanese II	90	3			
Intermediate Japanese	90	3						

Category	Group	Subject	Total class hours	Credits	Comments	
Basics of Discipline	Basics of Humanities		30	2	The dean of each faculty shall determine annually which courses may be taken by students of other faculties as General Education Subjects.	
	Basics of Social Sciences		30	2		
	Basics of Mathematics	Linear Algebra A		30	2	
		Linear Algebra B		30	2	
		Calculus A		30	2	
		Calculus B		30	2	
		Ordinary Differential Equations		30	2	
		Complex Function Theory		30	2	
		Probability & Statistics		30	2	
	Basics of Physics	Physics A		30	2	
		Physics B		30	2	
		Physics C		30	2	
		Basic Mathematics for Physics		30	2	
	Basics of Chemistry	Chemistry A		30	2	
		Chemistry B		30	2	
		Chemistry C		30	2	
	Basics of Biology	Biology A		30	2	
		Biology B		30	2	
		Biology C		30	2	
	Basics of Earth and Space Science	Earth System Science		30	2	
		Earth Material Science		30	2	
		Geography		30	2	
		Astronomy		30	2	
Geophysics			30	2		



# ● Kawauchi Campus Map

## (1) Campus Map

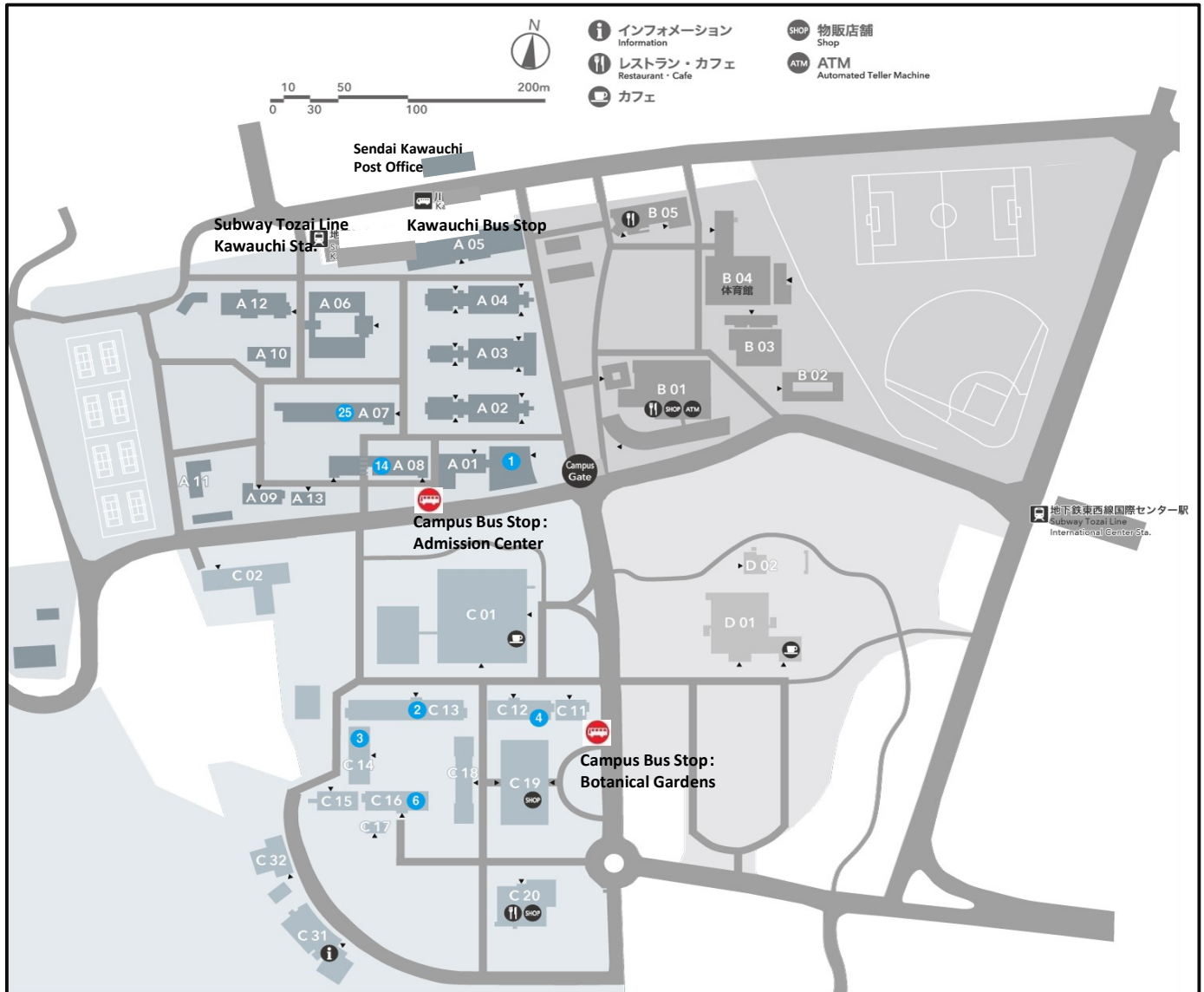

A 01	Education and Student Support Center
A 02	Lecture Rooms A
A 03	Lecture Rooms B
A 04	Lecture Rooms C
A 05	Multimedia Education and Research Complex
A 06	Student Laboratories
A 07	Center for Northeast Asian Studies, Office, Kawakita Research Forum
A 08	Graduate School of International Cultural Studies, Office
A 09	Student Health Care Center
A 10	Disability Services Office
A 12	International Exchange Building
A 13	Counseling Office
B 01	Kawauchi Welfare Facilities
B 02	Kawauchi Circle and Club Building
B 03	Kawauchi Extracurricular Activity Shared Facilities (Kawauchi Hall)
B 04	Kawauchi Gymnasium (Kawauchi Arena)
B 05	Kawauchi Sub Arena
C 01	Tohoku University Library
C 02	Admission Center
C 12	Graduate School / School of Law, Office
C 13	Graduate School / Faculty of Arts and Letters, Office
C 14	Graduate School / Faculty of Education, Office, New Humanities Building
C 16	Graduate School / Faculty of Economics and Management, Office
C 18	Lecture Rooms
C 19	Multidisciplinary Research Building, International Oasis
C 20	Welfare Facilities (Maple Park Kawauchi)
C 31	Botanical Gardens (Garden Hall)
D 01	Centennial Hall (Kawauchi Hagi Hall)

## (2) Classroom

( ) = the seating capacity

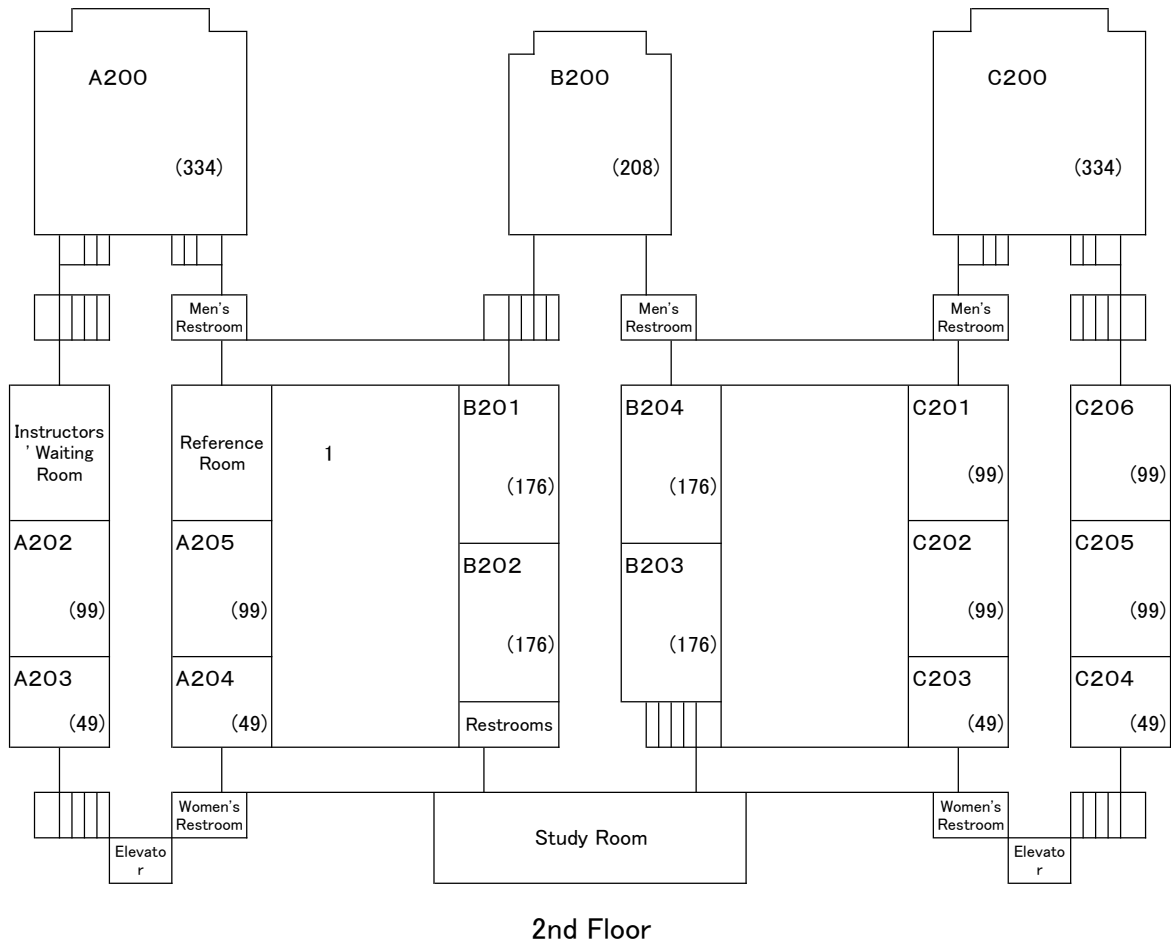
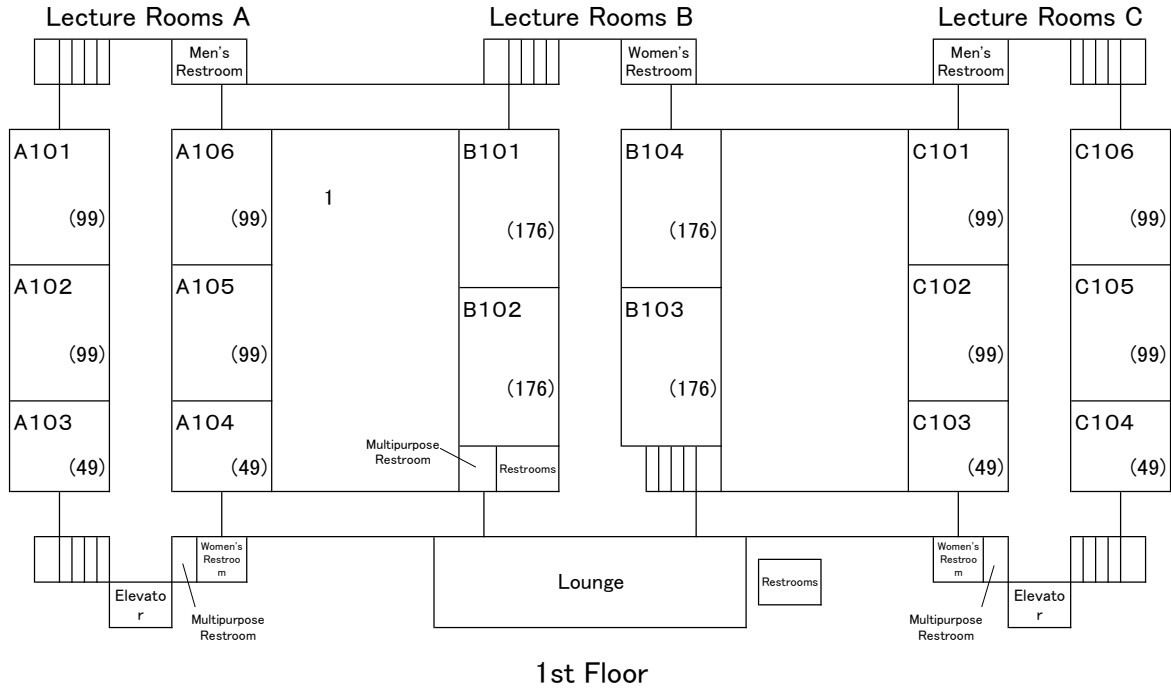

### Lecture Rooms A

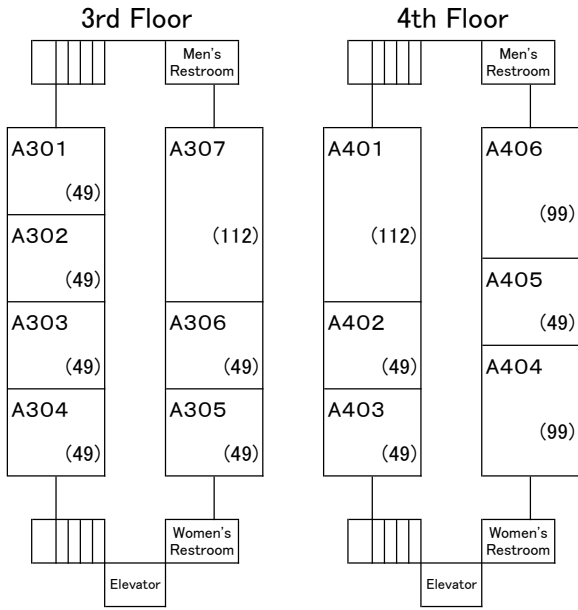

### Lecture Rooms C

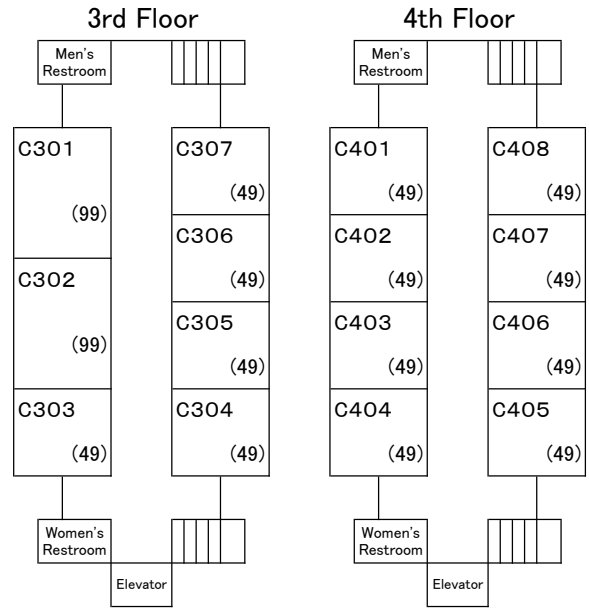

## (3) Student Laboratories

### 1st Floor

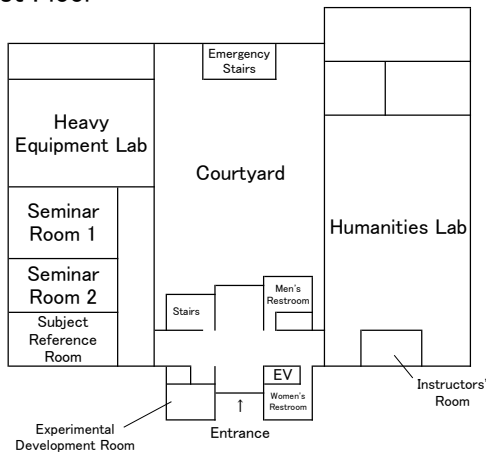

### 2nd Floor

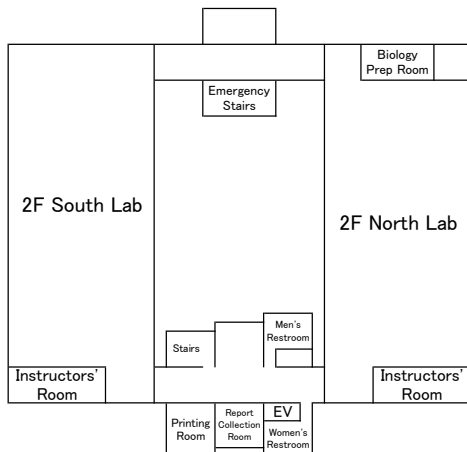

### 3rd Floor

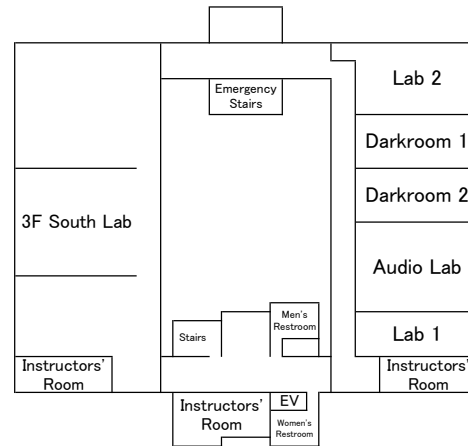

### (4) Multimedia Education and Research Complex

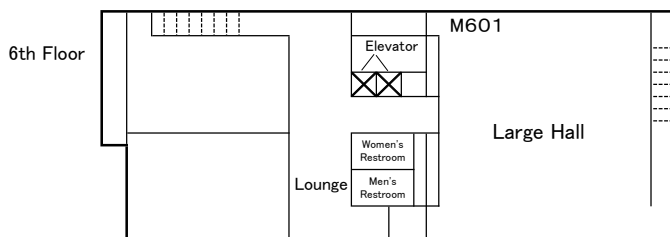
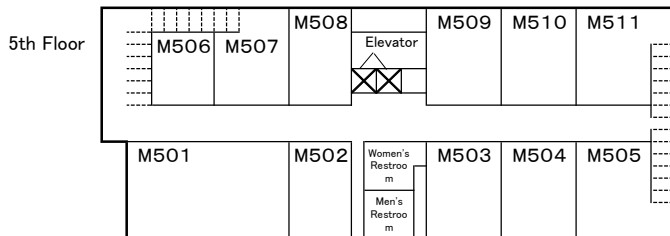
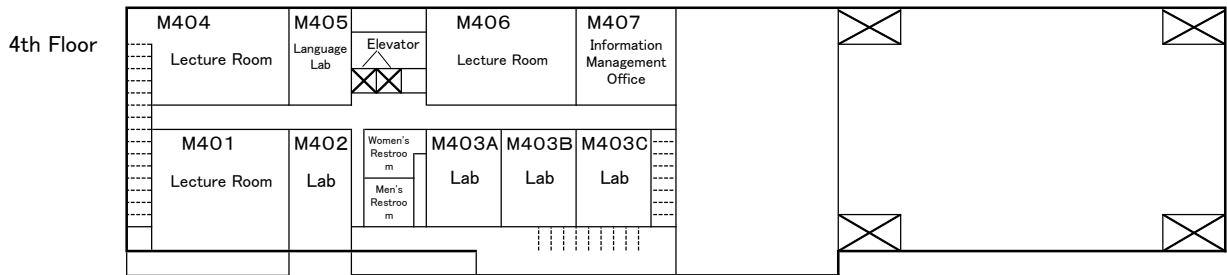
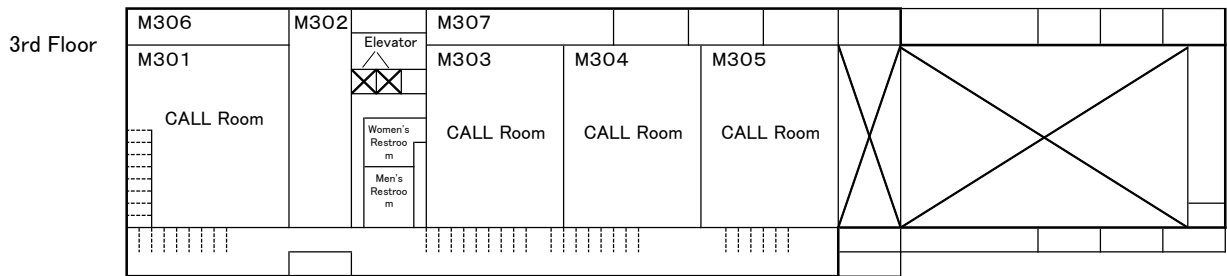
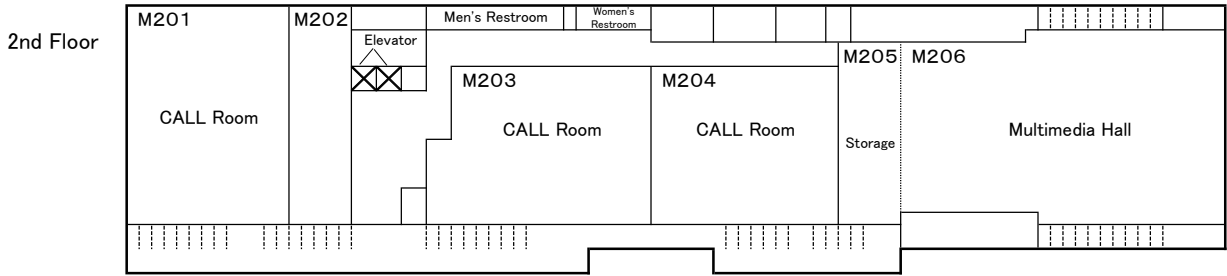
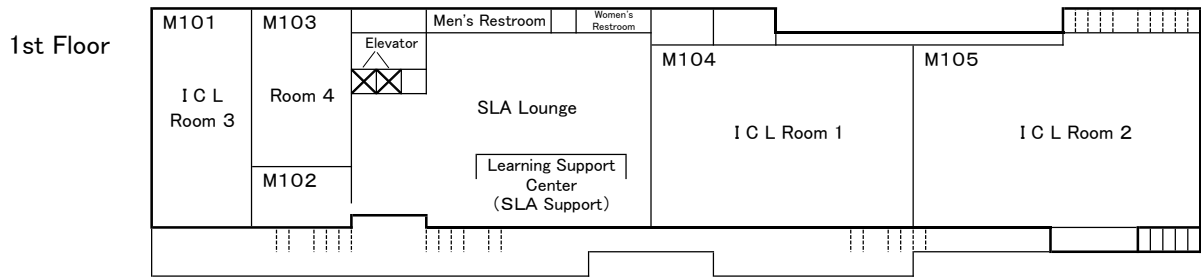

## (5) Gymnasium

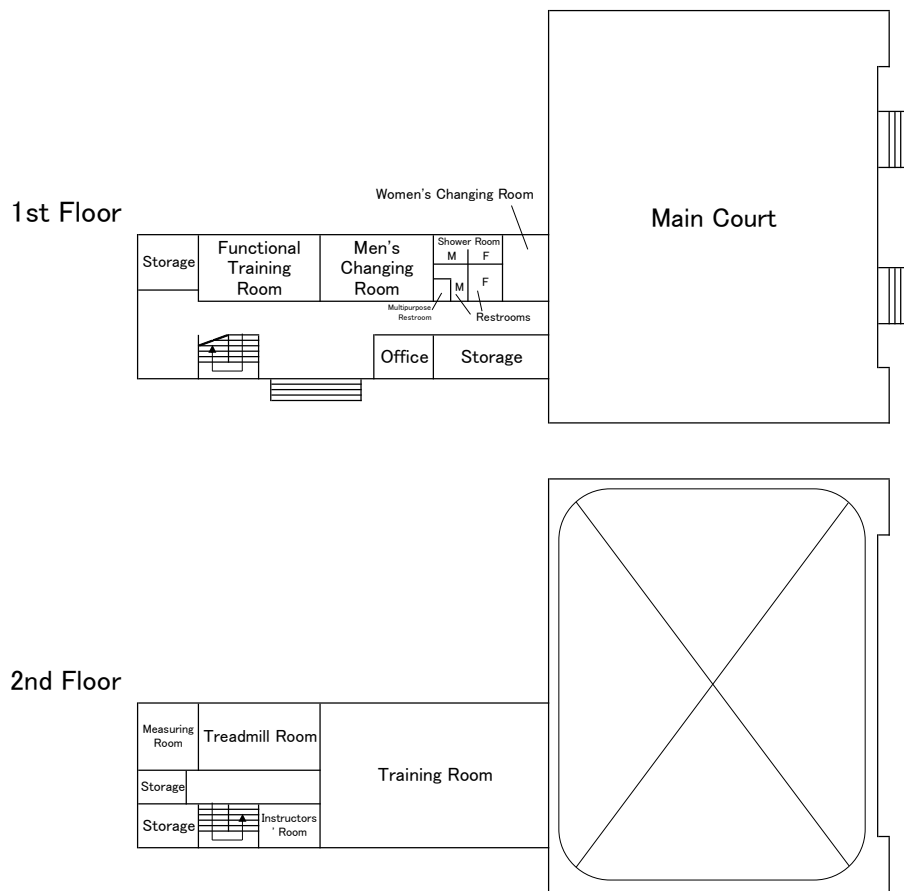

## (6) Sub Arena

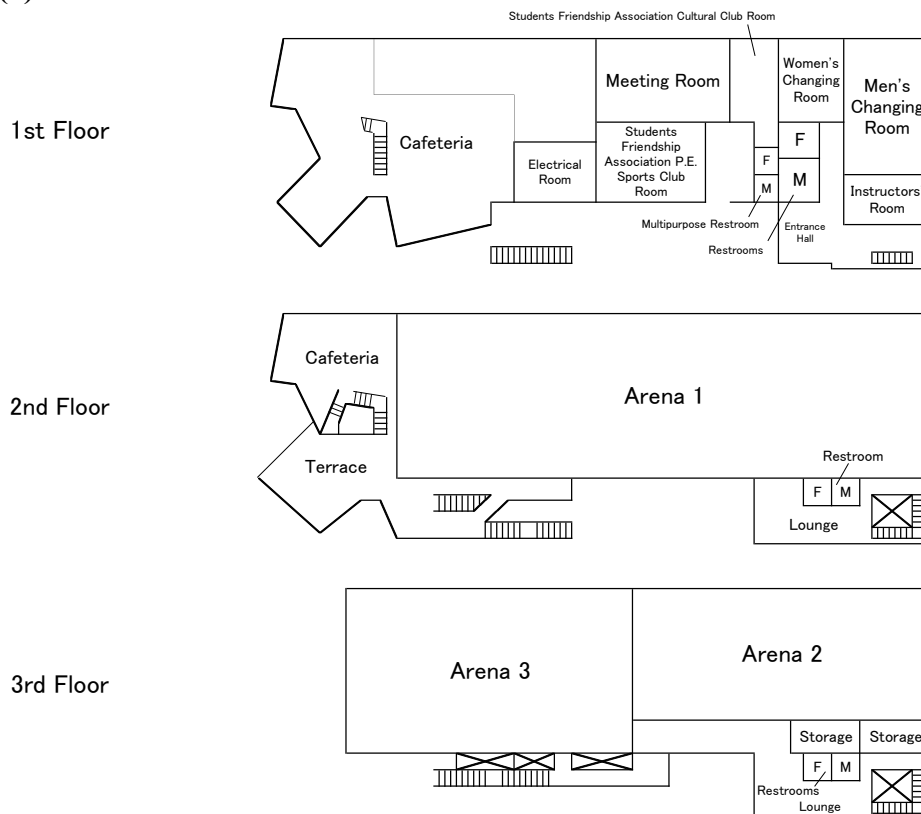

**(7) Education and Student Support Center, Student Services [A01]**

<b>Student Support Division (1<sup>st</sup> floor)</b>	
1	Support Planning Section -Lost & Found -Change of personal information (address, contact information etc.) -Thefts/crimes/accidents -Enrollment/invoicing for personal accident (Gakkensai) & liability (Inbound futai-gakuso) insurance -National Pension Plan
2	Activity Support Section -Circles/clubs -Equipment loan
3	Student Life Support Section -University House, dormitories
4	Financial Support Section -Waiver or deferment of entrance fee/tuition -Scholarships (for Japanese students) -Student Commuter Certificate
<b>Educational Affairs Division (2<sup>nd</sup> floor)</b>	
5	Educational Records and Programs Section Educational Programs Section General Education Planning Section Liberal Education Operating Section -General Education classes
<b>Student Exchange Division (2<sup>nd</sup> floor)</b>	
6-A	General Affairs Section -Tohoku University International House/University House
6-B	International Education Section -Future Global Leadership Undergraduate Courses (= FGL Office) -Special curriculum (Japanese language) for international students -Scholarships (Japanese Government Scholarship, Honors Scholarship etc.)
6-C	Incoming Student Exchange Section -Incoming student exchange programs -Double Degree (Joint Education) Program (incoming)
6-D	Global Programs Section -TGL Program -Outgoing overseas programs (Study Abroad Program (SAP)/exchanges/COLABS) -English language learning -Scholarships for outgoing studies abroad
7	International Support Office -Resident Status, private apartments
<b>Center for Career Support (3<sup>rd</sup> floor)</b>	
8	Careers Advisory Section -Counseling and information on student career paths and job-finding -Internships and part-time employment

3<sup>rd</sup> floor of the West Wing: **Global Learning Center**

## (8) International Exchange Building [A12]

The offices of professors' who teach General Education Subjects are located on the second floor of the International Exchange Building.

